

**Map 6. Telegraph Lines At Applegate Trail
North Sexton Pass I-5 West: 1940¹**

January 6, 2012

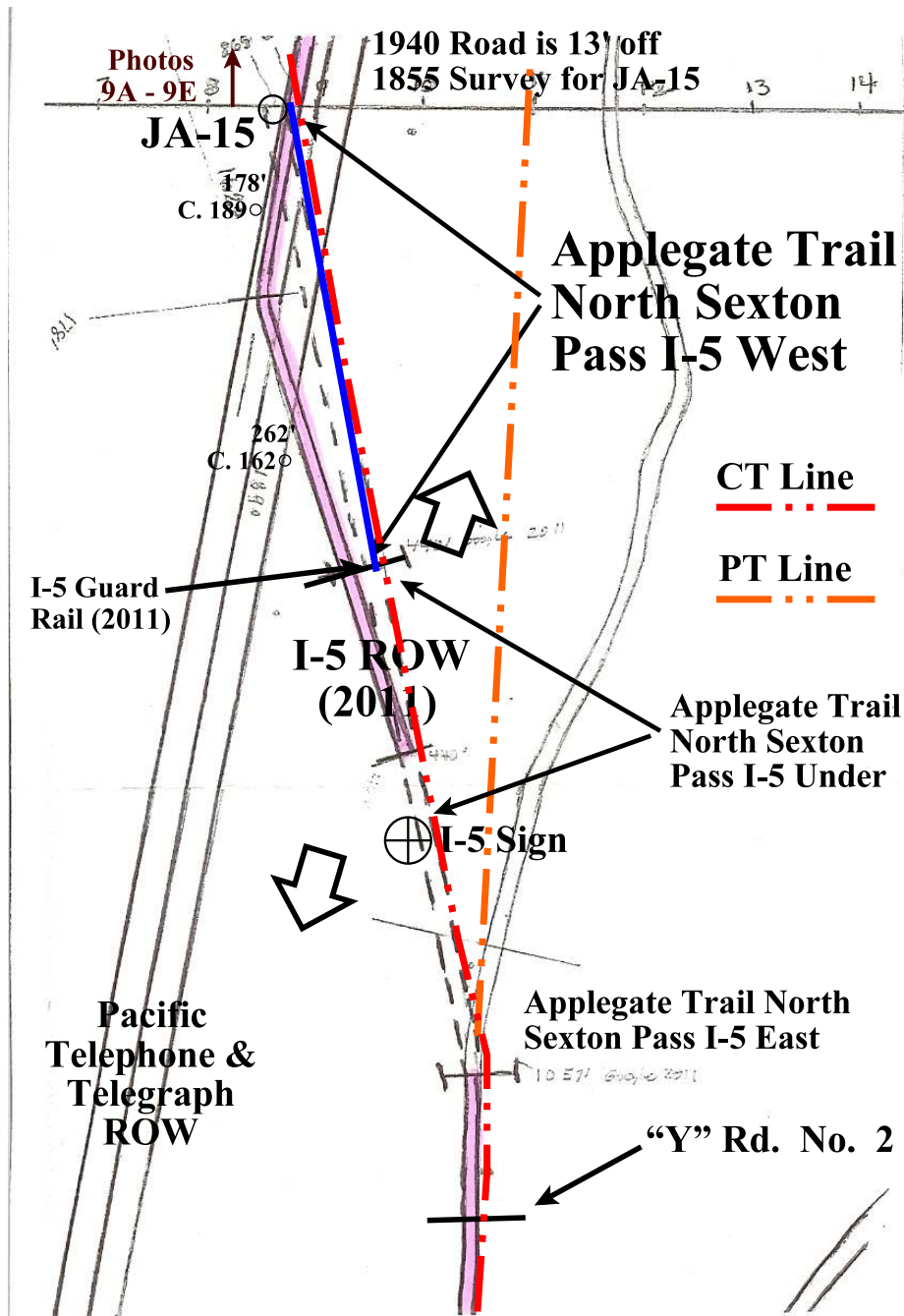

1. Base Map is Oregon State Highway Department. August 1940. *Right of Way Map, Sexton Mt. Section. Pacific Highway, Josephine County.* Scale 1" = 100'. Part 1 of 2, Drg. No. 5B-28-11

C:\Documents and Settings\mike\My Documents\Genealogy\History_Brochures\Insulators\Telegraph and Applegate Trail Paper\Maps\Map 6_North Sexton Pass I5 West 1940.wpd