

**Map 3. Telegraph Lines South Of Smith Hill Pass: 1940**

January 6, 2012

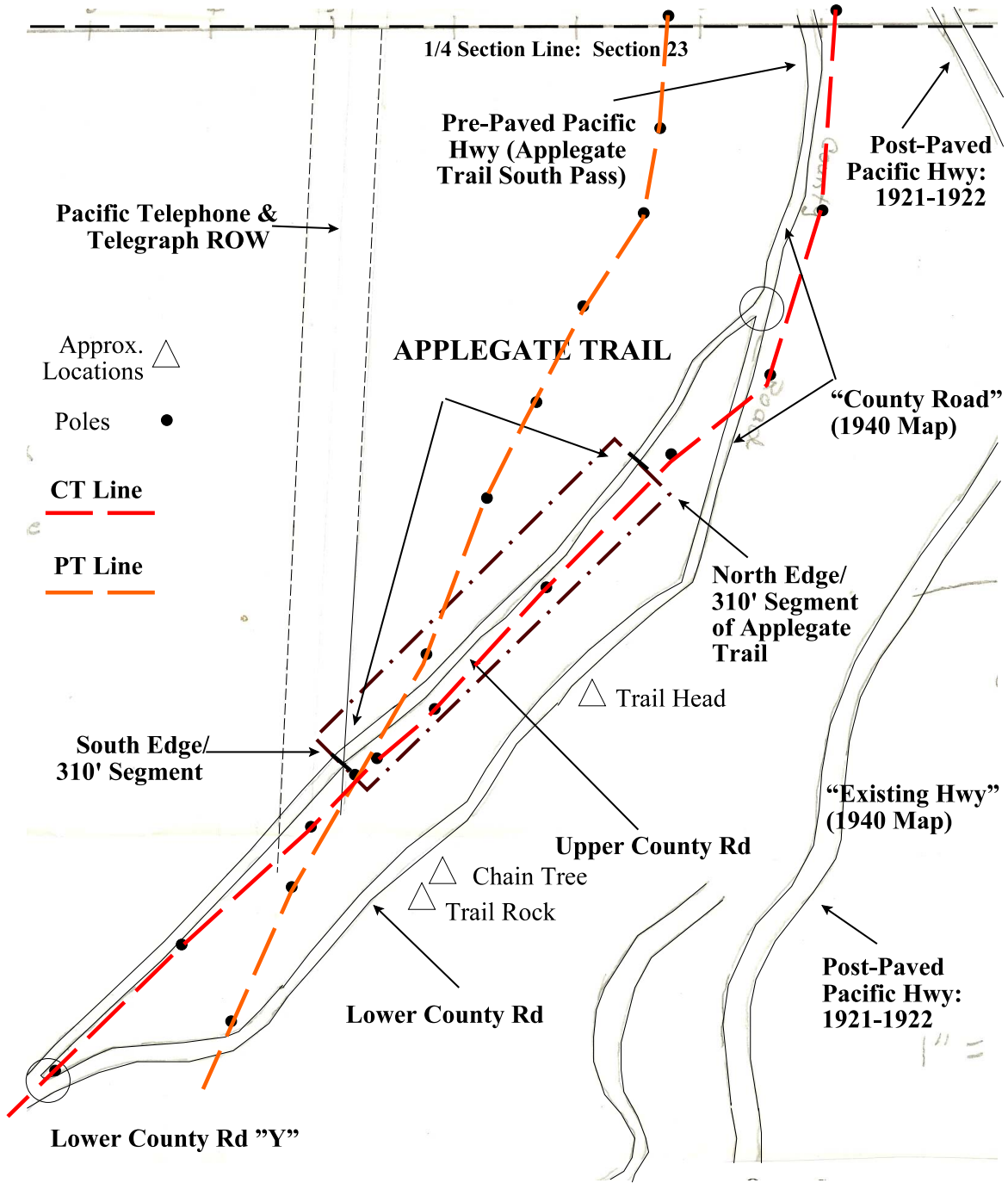

**Map 3. County Roads & Pacific Hwy South Of Smith Hill Pass: 1940**

Base Map Oregon Pacific Highway Map: 1940

Oregon State Highway Department. August 1940. *Right of Way Map, Sexton Mt. Section. Pacific Highway, Josephine County.* Scale 1" = 100'. Part 1 of 2, Drg. No. 5B-28-11

C:\Documents and Settings\mike\My Documents\Genealogy\History\_Brochures\Insulators\Telegraph and Applegate Trail Paper\Maps\Map 3\_County Roads South Of Smith Hill Pass 1940.wpd