

**General Land Office (GLO) Surveyed Points of Interest (POIs):
1893 JA-15 South Rat Creek to 1855 JA-16 Old Stage Road: 1932**

**Map 9. Roads In Rat Creek: 1932
Base Map: 1932 Metsker Map¹**

September 2, 2010 The 1932 Metsker Map clearly shows a unimproved road west of Rat Creek from Mt. Sexton Pass down past JA-16 and no roads on the east side except the Pacific Highway uphill to the east.

The dark black line is the paved 1920 - 1921 Pacific Highway in 1932.

1855 JA-16 plots in Rat Creek which is much further east than 1932 road which is west of creek.

1855 GLO Survey Notes for POI Page 605. Subdivisions of T. 34 S., R. 6 W. 89.46 W [West] on True Line between sections 11 & 14.

Chains

72.00 a Road c N30°W & S30°E
[72 chains = 4,752']

1893 GLO JA-15 plots on the 1932 road; road is west of Rat Creek if creek is extended south.

1993 GLO Survey Notes for POI Pages 462 - 463. Subdivisions of T. 34 S., R. 6 W. - Thence I run N89°13'E. [East] on a true line bet [between] Secs [sections] 14 & 23 Var 19°E at 9 a.m.

Chains

13.10 Grants Pass and Canyonville Roads course N. and S. (13.1 chains = 864.6'; Rat Creek was 92.4' from road]

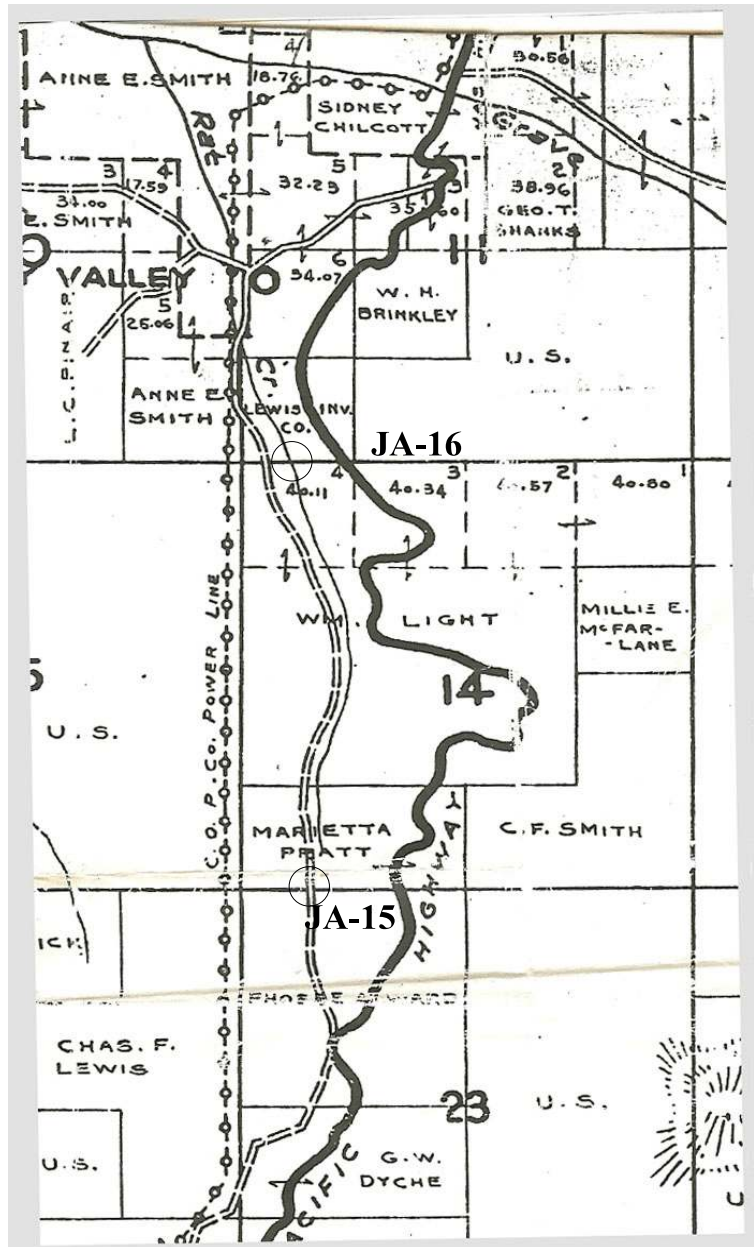

Footnote 1. Metsher, Chas. F. 1932 Metsker Map. Josephine County, Oregon. Portland, OR.