

Map 3. County Roads South Of Smith Hill Pass: 1940

January 11, 2012

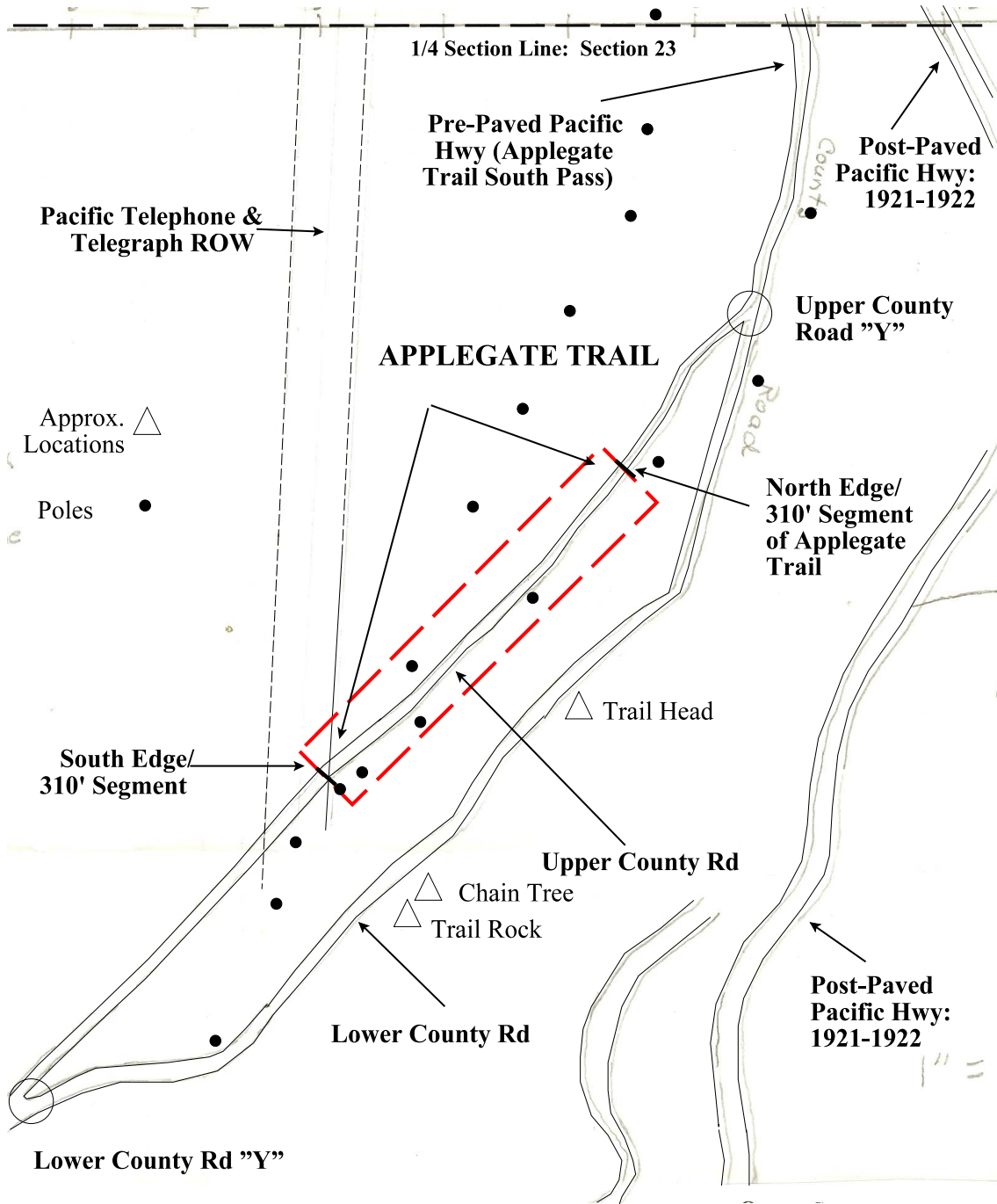

Map 3. County Roads & Pacific Hwy South Of Smith Hill Pass: 1940
Base Map Oregon Pacific Highway Map: 1940

Oregon State Highway Department. August 1940. *Right of Way Map, Sexton Mt. Section. Pacific Highway, Josephine County.* Scale 1" = 100'. Part 1 of 2, Drg. No. 5B-28-11

C:\Documents and Settings\mike\My Documents\Genealogy\Applegate Trail GLO Surveyed Points\JA15 South Rat Creek\North Sexton Pass\Map 3_County Roads South Of Smith Hill Pass 1940.wpd