

Minutes of Field Trip

JA-6 Harris Road 3 (Pond) JA-7 Harris Road 4 (Office)



General Land Office Field Survey Sub-Committee Hugo Emigrant Trails Committee Hugo Neighborhood Association & Historical Society Inventory Trip, August 11, 2011 Field Trip 10:00 a.m. - Noon

I. PURPOSE Members of the General Land Office (GLO) Field Sub-Committee (*SubCommittee*), Hugo Emigrant Trails Committee, previously conducted pedestrian surveys of two Jacksonville Road of the Applegate Trail (*Trail*) sites: JA-6A and JA-7A. Their primary office tools were public (i.e., GLO and donation land claim (DLC) survey notes and maps) and private surveys, diaries, journals and reminiscences.

Previous Minutes

1. Minutes of Field Trip to JA-6A Harris Road 3 (Pond), *SubCommittee* Inventory Trip, May 12, 2010.
2. Minutes of Field Trip to JA-7A Harris Road 4 (Office) *SubCommittee* Inventory Trip, Thursday, May 12, 2010

Web Published *Trail* Inventory Brochures

(<http://www.hugoneighborhood.org/inventorybrochures.htm>)

1. JA-6A Harris Road 3 (Pond)
http://www.hugoneighborhood.org/JA_Harris_Road_3_JA6_Pond_bro.htm
2. JA-7A Harris Road 4 (Office)
http://www.hugoneighborhood.org/JA_Harris_Road_4_JA7_Office_bro.htm



The purpose of the August 11, 2011 field trip was to place professional carsonite markers with information decals at two 1850s surveys sites along the Jacksonville Road of the *Trail*.

Photo 1. NWOCTA Marker At JA-7A

II. SPONSORS This *SubCommittee* work has four co-sponsors: Hugo Neighborhood Association & Historical Society (*Hugo Neighborhood*), Josephine County Historical Society

(JCHS), Josephine County Sportsman Association (JCSA), and the NW Chapter of Oregon-California Trails Association (OCTA).

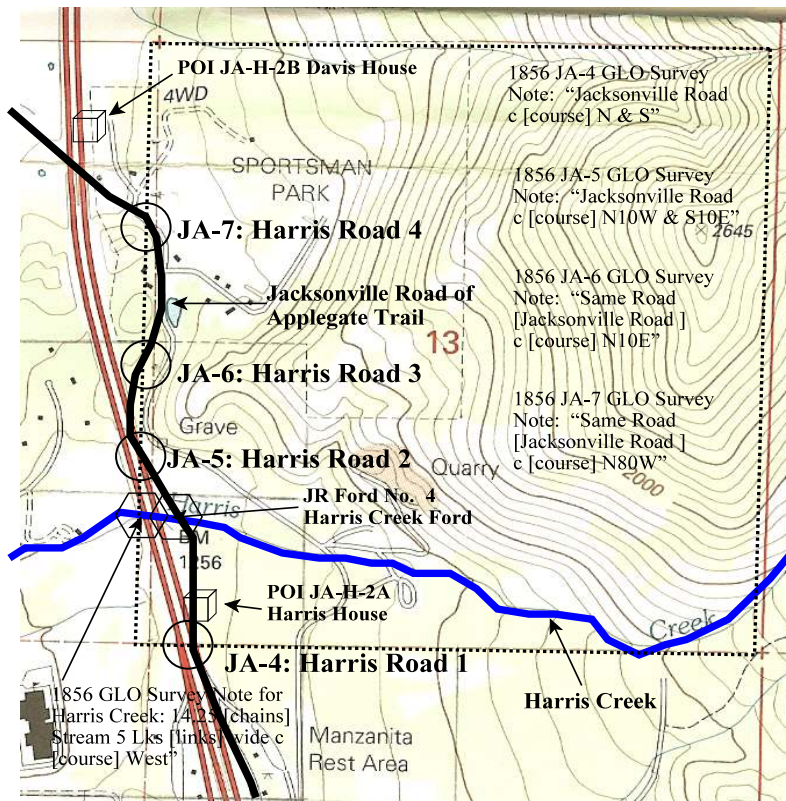

Map 1. JA-6 and JA-7

GLO Subcommittee in researching, inventorying, and marking the *Trail* in northern Josephine County from the Rogue River in the south to Grave Creek in the north: Glen Campbell, Jim Ford, Rene Ford, Joe Neiderheiser, Kelly Rarey, Mike Walker, and Chris Wytcherley. The sites are researched, located, mapped, and marked by the Subcommittee using the inventory methodology described in OCTA's *Mapping Emigrant Trails Manual* (MET), including the composite trail description method of integrating diaries, journals, reminiscences, aerial photographs, and government reports.

The first step in locating the *Trail* sites is through the use of accurate historical and modern government survey notes (i.e., the 1850s GLO survey notes and maps, 1850s donation land claim (DLC) survey notes and maps, modern local Josephine County surveys (C.S.) and maps, and the GPS, including bearing and distance measurements). This method is being used because after 150 years the *Trail* in wet

III. PARTICIPANTS There were 14 members of the *SubCommittee* and co-sponsor representatives that participated on this field trip (Appendix A).

IV. ACCOMPLISHMENTS JA-6A and JA-7A were located and marked with professional carsonite markers donated by NWOCTA.

V. BACKGROUND A wealth of information on the *Trail* can be found at the *Hugo Neighborhood's* web page (<http://www.hugoneighborhood.org/applegat.htm>). Please be respectful and *do not trespass*. Many *Trail* sites are located on private property not open to the public.

This marking action is one of the last steps of the seven-member



Photo 2. Mike Walker Discussing Applegate Trail Marking Program

western Oregon is usually buried beneath 6 - 12 inches of soil and debris. In the field what is usually seen is the participant's imagination. Ruts are gone and traces are few, but a verified



Photo 3. Participants At JCSA Office

“surveyed” *Trail* site can make sense of the local terrain where there are several skid roads, and faint traces aligned along the recorded course of the *Trail* which clear up otherwise normally appearing swales. And, on occasion, the mystery of a cairn appears at the end of a GPS or C.S. track.

Eventually mother nature and/or development will bury all our historic emigrant trails, even those in the high dry deserts. However, the archeological approach is accepted and treasured by people, especially urban dwellers, as it opens up the excitement of the scientific

method and the imagination of the modern pioneer trail discoverer. Of great excitement is a recent Oregon Department of Transportation (ODOT) sponsored survey conducted by University of Oregon archeologists. In the process of their using the archeological approach, they corroborated the Hugo Emigrant Trails Committee's use of the MET (i.e., artifacts supported MET and MET surveys supported artifacts for a more conclusive picture of the *Trail*). In April of this year the UO published the results of this survey undertaken as part of the ODOT's Chancellor Quarry Stockpile Project (Museum of Natural & Cultural History, University of Oregon. April 2011. University of Oregon Museum of Natural and Cultural History's Report No. 2011-002, *Subsurface Reconnaissance of the I-5 Chancellor Quarry Stockpile Project, and Metal Detector Survey within the George and Mary Harris 1854-55 DLC (35J0246), Josephine County*).

These verified surveyed *Trail* sites greatly facilitate the search for the *Trail* by showing the researcher where to look for *Trail* traces. They help solve the mystery of several trail traces or logging skid roads in the vicinity and in determining and verifying which of the traces or evolved roads are related to emigrant wagon use. For example, now that you are looking at the terrain at the surveyed site, where would you really travel as a high-centered wagon hating wet areas and sideling?



Photo 4. Karen Rose Speaking About Emigrants At JA-7A

When encountering hills on steep ascents or descents, wagons normally traveled directly up or down to avoid sideling or side hilling on steep slopes, and the real possibility of tipping over.

An effective means of applying diaries, journals, reminiscences, and government reports, including GLO survey notes and maps, to locate and verify particularly vexing segments of emigrant trails is creating a composite trail description. You begin by gathering together as many accounts as possible that describe in any way the trail segment under study. Descriptions, for example, could include references to rivers and creeks, fords, mountains, bluffs, ridges, ravines, roads (i.e., Road from Willamette Valley to Jacksonville and Road to Illinois Valley via Van Noys Ferry), forks in the *Trail*, and any distances or directions recorded. Arranging all of these descriptions — really clues — in some kind of sequential order will reveal the course, direction, and location of the trail. In this way, a detailed composite description of the trail segment under study can be created. Diaries, journals, and reminiscences that describe human thoughts, actions,

and fears for a particular trail segment bring the physical terrain alive with human suffering and hope for the future.



Photo 5. Kelly (HNA&HS), Gale (JCSA), Michele (JCSA), & Michael (JCSA) At JA-7A

The accuracy of the 1850s GLO and DLC surveys has been verified by local surveyors in Josephine County, Oregon as well as an independent researcher (Atwood, Kay. 2008. *Chaining Oregon*, Surveying the Public Lands of the Pacific Northwest: 1851 - 1855. McDonald & Woodward Publishing Company. Granville, OH).

In northern Josephine County the 1850s surveys for the Rogue Valley, except for the later Rogue River ferries,

accurately reflect the emigrant wagon use from 1846 - 1855. The rationale is simple. There were not many settlers in the Rogue Valley that needed improved year around roads until the Indians were defeated and moved out the valley in 1856. In 1855 there were only five settler families in the entire Jump-off Joe Creek drainage: Haines, Harris, Niday, Wagner, and Walker brothers. Except for the Harris cabin, all these families were burned out by the Rogues on October 9, 1855. Until late 1855 - 1856 emigrants were mainly on a one-way fall/winter route north to the Willamette Valley. These emigrants were not building, improving, or relocating the *Trail* for year around use to avoid the wet bottoms of winter. They were not dallying in the valley checking out possible settlement sites. They were moving as fast as they could north through the dry bottom lands and ridges of October and trying to avoid an encounter with hostiles.

VI. JA-6A HARRIS ROAD 3 (POND)

Road POI Name Harris Road 3 (Pond) ■ JA-6A.

POI ID Code OR-AG-23-35-06-13/14-N-JA-06-A.

For additional information see minutes of field trip to JA-6 Harris Road 3 (Pond), *SubCommittee* inventory trip, May 12, 2010.

VII. JA-7A HARRIS ROAD 4 (OFFICE)

POI Name Harris Road 4 (Office) ■ JA-7A.

POI ID Code OR-AG-23-35-06-13/14-N-JA-07-A.

For additional information see minutes of field trip to JA-7 Harris Road 4 (Office) *SubCommittee* inventory trip, Thursday, May 12, 2010.

VIII. TRAIL CLASSIFICATION

The OCTA trail classification of JA-6A is Class 3 - Verified Trail, and JA-7A is Class 4 - Verified Altered Trail.

IX. BE RESPECTFUL *Do not trespass.*

1. JA-6A is located on JCSA public property open to the public; check in at the JCSA office and let them know you are visiting.
2. JA-7A is located on JCSA public property open to the public; check in at the JCSA office and let them know you are visiting as the site is part of an archery range; you do not want to be there when the arrows are flying



Photo 6. Richard Marshall, JCHS, & Michele Shearer, JCSA, At JA-6A

XI. MINUTES

Minutes recorded by Mike Walker: August 23, 2011

Mike Walker, Minutes Secretary & Member
GLO Field Review Sub-Committee
Hugo Emigrant Trails Committee
Hugo Neighborhood Association & Historical Society
3388B Merlin Rd #195
Grants Pass, Oregon 97526
541-471-8271
Email: hugo@jeffnet.org
Web Page: <http://www.hugoneighborhood.org/>

Minutes were reviewed, edited, and approved by the following participating members of the *Sub-Committee*: Joe Neiderheiser, Kelly Rarey, and Mike Walker; and Karen Rose, Co-Project Leader, Hugo Emigrant Trails Committee.

Email Copies of Final Minutes: Members of *Sub-Committee*; Karen Rose, Co-Project Leader, Hugo Emigrant Trails Committee, and other participants of field trip.

The final minutes are public and can be shared by participants of the field trip as they determine desirable.

**Appendix A. August 11, 2011 Field Trip Participants
Jacksonville Road of Applegate Trial Sites JA-6A & JA-&A**

GLO Field Review *SubCommittee* Members

1. Glen Campbell, *Hugo Neighborhood*
2. Joe Neiderheiser, *Hugo Neighborhood & NWOCTA*
3. Kelly Rarey, *Hugo Neighborhood*
4. Mike Walker, *Hugo Neighborhood & NWOCTA*

Other Participants

1. Michael House, Range Manager, JCSA
2. Gale Johnson, Past Director, JCSA
3. Richard Marshall, Director, JCHS
4. Kathy Marshall, Director, JCHS
5. Wayne McKy, Chair, *Hugo Neighborhood*
6. Janet McKy, Member, *Hugo Neighborhood*
7. Karen Rose, Co-Project Leader, Hugo Emigrant Trails Committee & NWOCTA
8. Michele Shearer, Director, JCSA
9. Gary Swanson, Director, JCHS
10. Wendy Swanson, Director, JCHS



Photo 7. Participants At JA-6A: Glen, Joe, Kathy, Mike, Wendy, Kelly, Gary, Wayne, Michele, and Janet.