

Sylvester & Effie Decker, Hugo's Early Settlers

For purposes of the Hugo's Settler brochure series, an early Hugo settler includes anyone who lived there sometime from 1900 through the 1930s.

Sylvester P. Decker

Born:
Birth Place:
Father's Birth Place:
Mother's Birth Place:

Effie Decker

Born:
Birth Place:
Father's Birth Place:
Mother's Birth Place:

Sylvester Decker Family, Early Hugo Settlers: ca., 1920s - 19??

1929 Sylvester Decker's Hugo Homestead On January 21, 1929 Effie and Sylvester P. Decker were issued a homestead certificate for 160 acres in Hugo, Oregon (Patent No.015846).¹⁻² The homestead was just south of the Southern Pacific Railroad's Tunnel No. 9.

1932 By 1932 C. W. Barnett was in possession of the Decker homestead.³

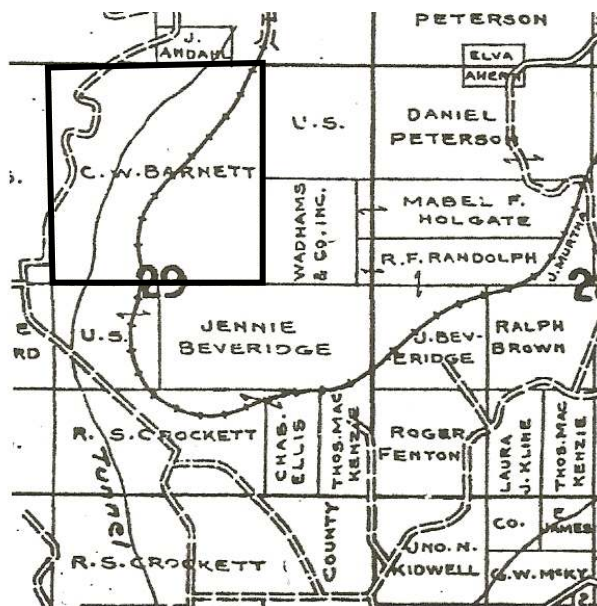

C. W. Barnett's Hugo Tract: 1932

Homesteader

Want more information? Contact an officer of the *Hugo Neighborhood* on how you can become involved in your community's history and land use.

1. Bureau of Land Management (BLM), General Land Office (GLO) Records. 2007. Official Federal Land Records Site (<http://www.glorerecords.blm.gov/>). Internet.
2. Hugo Neighborhood. 2007. *Hugo Pioneers*. Map Of Federal Land Transfer in Hugo, Oregon. Hugo, OR.
3. Metsher, Chas. F. 1932 *Metsker Map. Josephine County, Oregon*. Portland, OR.

Hugo Neighborhood Association & Historical Society's Mission

This information brochure is one of a series of documents published by the Hugo Neighborhood Association & Historical Society (*Hugo Neighborhood*). It is designed to be shared with neighbors for the purpose of helping protect our rural quality of life by promoting an informed citizenry in decision-making. The *Hugo Neighborhood* is an informal nonprofit charitable and educational organization with a land use and history mission of promoting the social welfare of its neighbors.

Land Use & History

The *Hugo Neighborhood's* land use mission is to promote Oregon Statewide Goal 1 — Citizen Involvement, and to preserve, protect, and enhance the livability and economic viability of its farms, forests, and rural neighbors. It will act, if requested, as a technical resource assisting neighbors to represent themselves.

Its history mission is to educate, collect, preserve, interpret, and research its local history and to encourage public interest in the history of the Hugo area.

Volunteer membership dues are \$10.00 annually per family and normally used for paper, ink, envelopes, publications and mailings. Send us your e-mail address if you want to know what we are doing.

Email: hugo@jeffnet.org

Web Page: <http://jeffnet.org/~hugo/>

Edited by Karen Rose, Wayne McKy, & Mike Walker

HNA&HS Officers

Hal Anthony, Outreach Chair
3995 Russell Road
Grants Pass, Oregon 97526

Wayne McKy, Chair
6497 Hugo Road
Grants Pass, Oregon 97526

Mike Walker, Education Chair
3388B Merlin Rd #195
Grants Pass, Oregon 97526

Karen Rose, Web Master
575 Red Mountain Drive
Grants Pass, Oregon 97526

SYLVESTER DECKER FAMILY: HUGO SETTLERS



Very Draft
Brochure 93 Of Hugo's Early Settler Brochure Series



William Willis Pat. 5034 (1883)	William M. Cox Patent 8847 (1902)	William Willis Pat. 5034 (1883)	Railroad Pat. 42 (1896)	Railroad Pat. 42 (1896)
Luther Williamson Pat. 14023 (1908)	BLM	BLM	BLM	BLM
Edward Dixon Patent 12054 1904	Albert Osborn Pat. 5091 (1901)	Railroad Pat. 42 (1896)	Harvey I Pat. 01 (193)	Char. Sexton Patent (189)
BLM	Sylvester Decker Pat. 015846 1929	BLM	Harison Triplett Pat. 2858 (1892)	Caroline Sexton Pat. 2633 (1870)
		John Gross Patent 2724 (1891)		

Sylvester Decker's Hugo Homestead: 1929

January 20, 2008

Hugo Neighborhood Association & Historical Society

Not Quality Controlled, Nor Edited

Brochure 93 in Hugo's Early Settler Brochure Series

HNA & HS 2007 - 93

C:\Documents and Settings\mike\My Documents\Genealogy\History_Brochures\People Settlers 1900 - 1930s\BROCHURE_93 Decker Sylvester 012008.wpd