

## Investor?



### William R. Willis

Born: 1825 Ohio  
 Father & Mother's Birth Place: Unkn Unkn

### Carrie A. Willis

Born: 1845 Illinois  
 Father's Birth Place: Ohio  
 Mother's Birth Place: Indiana

### 1880 Census. Roseburg Precinct, Douglas Co., OR

William R. Willis	Head	OH	1825	55 yrs
Carrie A. Willis	Wife	IL	1845	35 yrs
Lula Willis	Dau	OR	1865	15 yrs
Etta Willis	Dau	OR	1869	11 yrs
Belle Willis	Dau	OR	1874	6 yrs
Stephen D. Willis	Son	OR	1874	6 yrs
Leefoo		CH	1864	16 yrs

William Willis was an attorney-at-law. **Investor?**  
 Some data from McLane? Leefoo was born in China.

**1883 William Willis Cash Entry** Willis purchased 320 acres under Cash Entry No. 5034 in Josephine County, Oregon. It was issued March 10, 1883 to William R. Willis (April 24, 1820: Sale-Cash Entry (3 Stat. 566)).<sup>1-2</sup>

Of significance is the approximately 80 acres of the 320 acres at the north entrance of the Southern Pacific Railroad's Tunnel No. 9 which was completed in 1883.

## The William Willis, Early Investor: ca., 1880s - 18??

**1895** By 1895 Solomon Abraham owned the 80 acres as part of 280 acres of "40s" going north covering the railroad from Tunnel No. 9.

Solomon was a merchant that had purchased 160 acres under Cash Entry No. 662 in Josephine County, Oregon. It was issued August 15, 1865 to Solomon Et. Al. Abraham (April 24, 1820: Sale-Cash Entry (3 Stat. 566)).<sup>1-2</sup> This is the earliest cash entry sale in Hugo, except for the year before by Samuel Trimble. Both purchases were on the newly developed Applegate Trail. Soloman's purchase was also one of only three 160 acre cash entries in Hugo, Oregon.

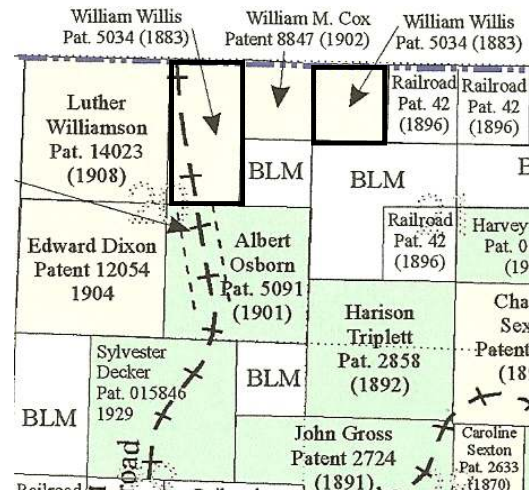

**William Willis Cash Entry: 1883**

## Southern Pacific Railroad & Tunnel No. 9

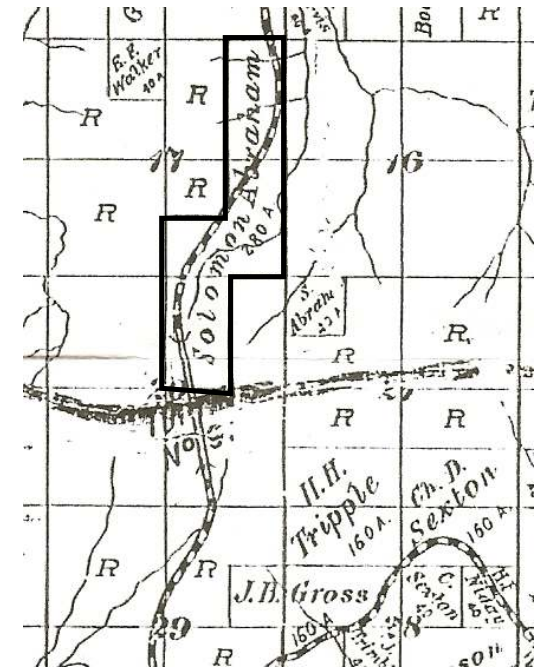

**Solomon Abraham's Railroad Lands: 1895**

**Want more information?** Contact an officer of the Hugo Neighborhood on how you can become involved in your community's history and land use.

1. Bureau of Land Management (BLM), General Land Office (GLO) Records. 2007. Official Federal Land Records Site (<http://www.glorerecords.blm.gov/>). Internet.  
 2. Hugo Neighborhood. 2007. *Hugo Pioneers*. Map Of Federal Land Transfer in Hugo, Oregon. Hugo, OR.3  
 3. Koch, Joseph , Draughtsman. 1895 Official Josephine County, Oregon. Map. Scale 1 inch = 1 mile. Meston - Dygert Book M'F'G. Portland, OR.

---

---

## Hugo Neighborhood Association & Historical Society's Mission

This information brochure is one of a series of documents published by the Hugo Neighborhood Association & Historical Society (*Hugo Neighborhood*). It is designed to be shared with neighbors for the purpose of helping protect our rural quality of life by promoting an informed citizenry in decision-making. The *Hugo Neighborhood* is an informal nonprofit charitable and educational organization with a land use and history mission of promoting the social welfare of its neighbors.

### Land Use & History

The *Hugo Neighborhood's* land use mission is to promote Oregon Statewide Goal 1 — Citizen Involvement, and to preserve, protect, and enhance the livability and economic viability of its farms, forests, and rural neighbors. It will act, if requested, as a technical resource assisting neighbors to represent themselves.

Its history mission is to educate, collect, preserve, interpret, and research its local history and to encourage public interest in the history of the Hugo area.

Volunteer membership dues are \$10.00 annually per family and normally used for paper, ink, envelopes, publications and mailings. Send us your e-mail address if you want to know what we are doing.

Email: [hugo@jeffnet.org](mailto:hugo@jeffnet.org)

Web Page: <http://www.hugoneighborhood.org/>

Edited by Jean Boling, Karen Rose,  
Wayne McKy, & Mike Walker

---

---

### HNA&HS Officers

Wayne McKy, Chair  
6497 Hugo Road  
Grants Pass, Oregon 97526

Mike Walker, Education Chair  
3388B Merlin Rd #195  
Grants Pass, Oregon 97526

### Web Master

Karen Rose, Web Master  
575 Red Mountain Drive  
Grants Pass, Oregon 97526

### Josephine County Historical Society

Jean Boling, Historic Sites Chair  
214 NW Booth Street  
Grants Pass, Oregon 97526

**Not Quality Controlled, Nor Edited**

Brochure 92 in Hugo's Pioneers Brochure Series  
HNA&HS 2008/2011 - 92

C:\Documents and Settings\mike\My Documents\Genealogy\History\_Brochures\People  
Pioneers 1800s\BROCHURE\_92 Willis William 011708.wpd

---

---

# WILLIAM WILLIS: EARLY INVESTOR?

**Very Draft**

Brochure 92 in Hugo's Pioneers Brochure Series



1998 Topo or  
1940 Aerial Photo

**January 18, 2008  
Updated July 5, 2011**

**Hugo Neighborhood Association &  
Historical Society**

**Josephine County Historical Society**