Hugo's Pioneers

William Willington

Born:

Birth Place:

Father's Birth Place:

Mother's Birth Place:

???

Born:

Birth Place:

Father's Birth Place:

Mother's Birth Place:



The William Whittington Family, Hugo Pioneers: ca., 1890s - 19??

1890 Veterans Schedules

William Whittington

Jump Off Joe Precinct, Josephine County, Oregon

Enlisted Private: July 1, 1861

Discharged Private: September 23, 1861

Company D, 4th Iowa Infantry Regiment

1895 William Whittington is proving up his homestead on the Southern Pacific Railroad just to the north of Coleman Hefling's homestead.¹

1896 William Whittington's **Hugo Homestead** On May 22, 1896 William Whittington was issued a homestead certificate for 80 acres in Hugo, Oregon (Patent No. 3672).^{2,3} This acreage is adjacent and to the north of the Three Pines Fruit Tracts and north of the Town of Three Pines, Oregon.

Homesteader

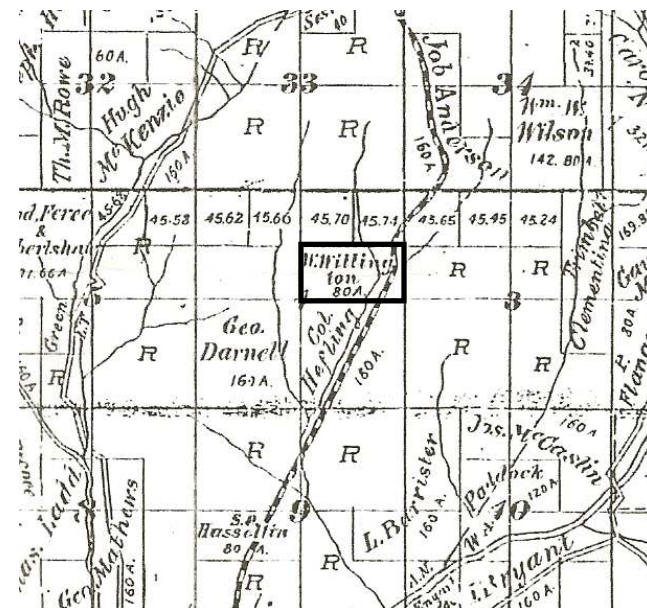

William Whittington's Hugo Homestead: 1895

Want more information? Contact an officer of the *Hugo Neighborhood* on how you can become involved in your community's history and land use.

1. Koch, Joseph, Draughtsman. 1895 Official Josephine County, Oregon. Map. Scale 1 inch = 1 mile. Meston - Dygert Book M'F'G. Portland, OR.
2. Bureau of Land Management (BLM), General Land Office (GLO) Records. 2007. Official Federal Land Records Site (<http://www.glorerecords.blm.gov/>). Internet.
3. Hugo Neighborhood. 2007. *Hugo Pioneers*. Map Of Federal Land Transfer in Hugo, Oregon. Hugo, OR.

Hugo Neighborhood Association & Historical Society's Mission

This information brochure is one of a series of documents published by the Hugo Neighborhood Association & Historical Society (*Hugo Neighborhood*). It is designed to be shared with neighbors for the purpose of helping protect our rural quality of life by promoting an informed citizenry in decision-making. The *Hugo Neighborhood* is an informal nonprofit charitable and educational organization with a land use and history mission of promoting the social welfare of its neighbors.

Land Use & History

The *Hugo Neighborhood's* land use mission is to promote Oregon Statewide Goal 1 — Citizen Involvement, and to preserve, protect, and enhance the livability and economic viability of its farms, forests, and rural neighbors. It will act, if requested, as a technical resource assisting neighbors to represent themselves.

Its history mission is to educate, collect, preserve, interpret, and research its local history and to encourage public interest in the history of the Hugo area.

Volunteer membership dues are \$10.00 annually per family and normally used for paper, ink, envelopes, publications and mailings. Send us your e-mail address if you want to know what we are doing.

Email: hugo@jeffnet.org

Web Page: <http://www.hugoneighborhood.org/>

Edited by Jean Boling, Karen Rose,

Wayne McKy, & Mike Walker

HNA&HS Officers

Wayne McKy, Chair
6497 Hugo Road
Grants Pass, Oregon 97526

Mike Walker, Education Chair
3388B Merlin Rd #195
Grants Pass, Oregon 97526

Web Master

Karen Rose, Web Master
575 Red Mountain Drive
Grants Pass, Oregon 97526

Josephine County Historical Society

Jean Boling, Historic Sites Chair
214 NW Booth Street
Grants Pass, Oregon 97526

WHITTINGTONS: HUGO PIONEERS

Very Draft

Brochure 91 in Hugo's Pioneers Brochure Series

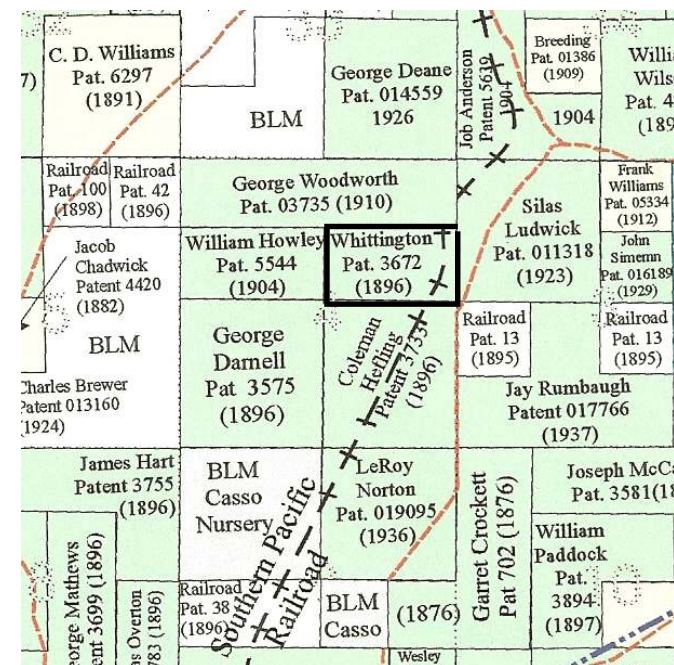

William Whittington's Hugo Homestead: 1896

Not Quality Controlled, Nor Edited

January 17, 2008
Updated July 5, 2011

Hugo Neighborhood Association &
Historical Society
Josephine County Historical Society