

“The Meadows” At Hugo, Oregon



William N. Triplett

Born: 1851 Pike County, MO
Died: January 6, 1886 Josephine Co., OR

Father: James Henry Triplett

Born: 1828 Pike County, IL or MO
Died: 1880 Josephine Co., OR?

Mother: Mary Jane (Swift) Triplett

1822 - 1871

Wife: Eveline (Murray) Triplett

Born: February 1856 Marion Co., OR
Died: 1902 Josephine Co., OR

1870 Census

James Henry Triplett

Mary Jane (Swift) Triplett

1. William D. Triplett MO 1851
2. Henry H. Triplett OR 1859
3. Clayborn W. Triplett OR 1861

1901: H. W. Triplett; Charley Triplett; Henry Triplett;
Harry Triplett

1906: C. Triplett; H. Triplett; Clabe Triplett; Harry
Triplett; C. W. Triplett

1908: C. W. Triplett; Jess Triplett (son of C. W.)

1902: Rosa Triplett

1911: Chas Triplett & Miss Anna B. McCallister

????: Brothers Harry & Cable Triplett

The Triplets, Hugo Pioneers

1874 William N. Triplett and Eveline “Evia” Murray married December 30, 1874 in Marion County, Oregon. They had five children.

Mary Ellen Triplett Feb. 1876, Oregon
James Edward Triplett Apr. 1878, Marion Co.
Henry A. Triplett Apr. 1880, Oregon
Rosa C. Triplett Feb. 1882, Josephine Co.
William D. Triplett Aug. 1885, Josephine Co.

1880 Census. Jump Off Joe & Galice Creek Precinct, Josephine County, Oregon

James Triplett	Father	MO	1827	53 yrs
Willaim Triplett	Son	MO	1851	29 yrs
Evia Triplett	D-in-law	OR	1855	25 yrs
Mary Triplett	G-dau	OR	1876	4 yrs
Edward Triplett	G-son	OR	1876	2 yrs
Henry Triplett	G-son	OR	1878	2 ms
Clayborn W. Triplett	Son	OR	1861	19 yrs
Henry H. Triplett	Son	OR	1859	21 yrs

William and Evia Triplett are married (Willaim N. Eveline Triplett).

1886 William N. Triplett passed January 6, 1886.

1892 Harison Triplett’s Hugo Homestead On

March 23, 1892 Harison H. Triplett was issued a homestead patent for 160 acres in Hugo, Oregon (Patent No. 2858).

Harison Triplett = Henry H. Triplett? Henry H. would have been 33 years old in 1892.

Federal Census

1900 Census. Merlin Precinct, Josephine Co., OR

Eveline Martin	Head	OR	1856	44 yrs
<u>James</u> E. Triplett	Son	OR	1878	22 yrs
<u>Henry</u> H. Triplett	Son	OR	1880	20 yrs
Rosa E. Triplett	Dau	OR	1882	18 yrs
<u>William</u> A. Triplett	Son	OR	1886	14 yrs
John Erving	Boarder	MO	1895	5 yrs
James C. Havelors	Boarder	MN	1882	18 yrs

Eveline Martin is Evia Triplett (see 1880 census). Perhaps Martin = Murray? Eveline was a farmer. James and Henry were railroad laborers.

1902 Eveline Triplett passed. “Mrs. Triplett was a widow, her husband, **Wm. Triplett**, having been drowned in the Rogue River some 17 years ago. She was 49 years of age. She leaves five children, three sons, and two daughters.”²

1910 Census. Merlin Precinct, Josephine Co., OR

C. W. Triplett	Head	OR	1861	49 yrs
Chas. Triplett	Son	OR	1889	21 yrs

C.W. Triplett was divorced.

1920 Census. Foots Creek Precinct, Jackson County, Oregon

Clayborne W. Triplett	Head	OR	1861	59 yrs
-----------------------	------	----	------	--------

Want more information? Contact an officer of the *Hugo Neighborhood* on how you can become involved in your community’s history and land use.

Hugo Neighborhood Association & Historical Society's Mission

This information brochure is one of a series of documents published by the Hugo Neighborhood Association & Historical Society (*Hugo Neighborhood*). It is designed to be shared with neighbors for the purpose of helping protect our rural quality of life by promoting an informed citizenry in decision-making. The *Hugo Neighborhood* is an informal nonprofit charitable and educational organization with a land use and history mission of promoting the social welfare of its neighbors.

Land Use & History

The *Hugo Neighborhood's* land use mission is to promote Oregon Statewide Goal 1 — Citizen Involvement, and to preserve, protect, and enhance the livability and economic viability of its farms, forests, and rural neighbors. It will act, if requested, as a technical resource assisting neighbors to represent themselves.

Its history mission is to educate, collect, preserve, interpret, and research its local history and to encourage public interest in the history of the Hugo area.

Volunteer membership dues are \$10.00 annually per family and normally used for paper, ink, envelopes, publications and mailings. Send us your e-mail address if you want to know what we are doing.

Email: hugo@jeffnet.org

Web Page: <http://www.hugoneighborhood.org/>

Edited by Jean Boling, Karen Rose,

Wayne McKy, & Mike Walker

HNA&HS Officers

Wayne McKy, Chair
6497 Hugo Road
Grants Pass, Oregon 97526

Mike Walker, Education Chair
3388B Merlin Rd #195
Grants Pass, Oregon 97526

Web Master

Karen Rose, Web Master
575 Red Mountain Drive
Grants Pass, Oregon 97526

Josephine County Historical Society

Jean Boling, Historic Sites Chair
214 NW Booth Street
Grants Pass, Oregon 97526

TRIPLETT FAMILY: JOSEPHINE COUNTY FEDERAL CENSUS

Draft

Brochure 85 in Hugo's Pioneers Brochure Series

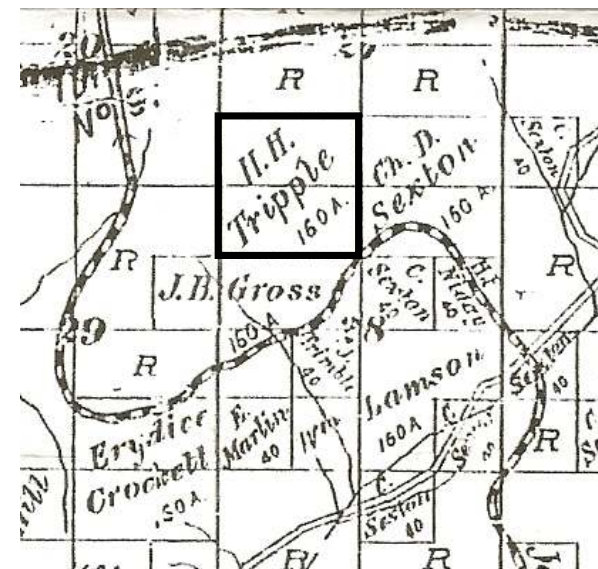

Harison H. Triplett's Hugo Homestead: 1895

Not Quality Controlled, Nor Edited

January 14, 2008
Updated July 5, 2011

Hugo Neighborhood Association &
Historical Society
Josephine County Historical Society

Brochure 85 in Hugo's Pioneers Brochure Series

HNA&HS 2008/2011 - 85

C:\Documents and Settings\mike\My Documents\Genealogy\History_Brochures\People Pioneers
1800s\BROCHURE_85 Triplett Census 011408.wpd