

John & Earl Case

?

Born:

Birth Place:

Father's Birth Place:

Mother's Birth Place:

Crocketts

1895 Garrett and Eurydica Crockett are living on the their 160 acre Hugo farm near Tunnel No. 9 (Eurydica's brother Mackinzie's old 1885 cash entry - Patent 5510).¹⁻³

1905 Judge Garrett Crockett Passed

1910 Census In 1910, Eurydica was living with her daughter Louesa C. and son-in-law Edward C. Dixon at 614 N 6th Street, Grants Pass, Oregon. It is assumed that Eurydica soon moved to Grants Pass after her husband's death and rented their Hugo farm for others to work.

1920 Census In 1920 both women are still in Grants Pass as widows.

1939 Eurydica Crockett Passed June 29, 1939.

Simple ancestry search for Josephine County, Oregon 1910 & 1920. 02/13/08 One Earl M. & Bessie Case in Jackson County in 1930.

The Case Family, Hugo Settlers: 19?? - 19??

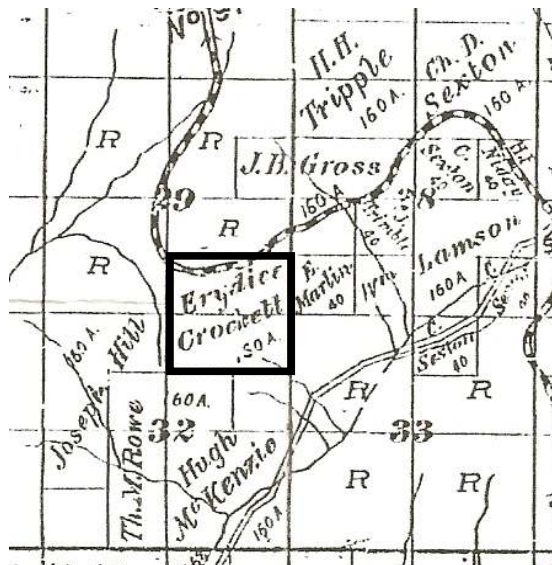

Crockett's Hugo Farm: 1895

1908 - late 1920s Prominent people worked the Crockett place in Tunnel Creek by the railroad tracts around 1908 - late 1920s. They probably built an old pole barn that is still there as the only barn on the Crockett place. It may be the oldest pole barn still standing in Hugo.⁴

Oldest Standing Pole Barn in Hugo, Oregon

1932 By 1932 R. S. Crockett was in possession of the Crockett acreage in Hugo, Oregon.⁵

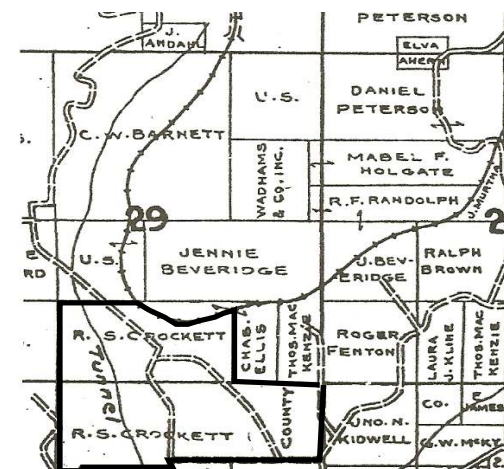

R. S. Crockett Ranch: 1932

Want more information? Contact an officer of the *Hugo Neighborhood* on how you can become involved in your community's history and land use.

1. Bureau of Land Management (BLM), General Land Office (GLO) Records. 2007. Official Federal Land Records Site (<http://www.glorerecords.blm.gov/>). Internet.
2. Hugo Neighborhood. 2007. *Hugo Pioneers*. Map Of Federal Land Transfer in Hugo, Oregon. Hugo, OR.
3. Koch, Joseph , Draughtsman. 1895 Official Josephine County, Oregon. Map. Scale 1 inch = 1 mile. Meston - Dygert Book M'F'G. Portland, OR.
4. Walker, Mike. February 12, 2008. *Wayne & Janet Mcky and DeLoss and Jeanette Downes Interview about Hugo Settlers*. Hugo, OR.
5. Metsher, Chas. F. 1932 *Metsker Map. Josephine County, Oregon*. Portland, OR.

Hugo Neighborhood Association & Historical Society's Mission

This information brochure is one of a series of documents published by the Hugo Neighborhood Association & Historical Society (*Hugo Neighborhood*). It is designed to be shared with neighbors for the purpose of helping protect our rural quality of life by promoting an informed citizenry in decision-making. The *Hugo Neighborhood* is an informal nonprofit charitable and educational organization with a land use and history mission of promoting the social welfare of its neighbors.

Land Use & History

The *Hugo Neighborhood's* land use mission is to promote Oregon Statewide Goal 1 — Citizen Involvement, and to preserve, protect, and enhance the livability and economic viability of its farms, forests, and rural neighbors. It will act, if requested, as a technical resource assisting neighbors to represent themselves.

Its history mission is to educate, collect, preserve, interpret, and research its local history and to encourage public interest in the history of the Hugo area.

Volunteer membership dues are \$10.00 annually per family and normally used for paper, ink, envelopes, publications and mailings. Send us your e-mail address if you want to know what we are doing.

Email: hugo@jeffnet.org
Web Page: <http://jeffnet.org/~hugo/>
Edited by Karen Rose, Wayne McKy, & Mike Walker

HNA&HS Officers

Hal Anthony, Outreach Chair
3995 Russell Road
Grants Pass, Oregon 97526

Wayne McKy, Chair
6497 Hugo Road
Grants Pass, Oregon 97526

Mike Walker, Education Chair
3388B Merlin Rd #195
Grants Pass, Oregon 97526

Karen Rose, Web Master
575 Red Mountain Drive
Grants Pass, Oregon 97526

Not Quality Controlled, Nor Edited

CASE FAMILY: HUGO SETTLERS



Very Draft
Brochure 65 Of Hugo's Early
Settler Brochure Series



February 13, 2008

**Hugo Neighborhood Association &
Historical Society**