

Lawrence & Ellen Brown

Lawrence E. Brown

Born: 1886 Kansas
Father & Mother's Birth Place: Illinois

Ellen (Markley) Brown

Born: 1891 Colorado
Father's Birth Place: Colorado
Mother's Birth Place: West Virginia

1920 Census. North Delta Precinct. Delta County, Colorado

Lawrence E. Brown	Head	KS	1886
Emma E. Brown	Wife	CO	1891
Lenore V. Brown	Daughter	CO	1914
Carrol E. Brown	Son	CO	1916
Lee R. Brown	Son	CO	1917

1922 The Brown family moved from Colorado to Compton, California.¹

1925 They then moved to Oakland, California.¹

1926 In May 1926 the Browns landed in Hugo, Oregon. Their land in Hugo was 20 acres in one piece and seven acres down the road. About four acres were cleared and they had a small creek, Bummer Creek, running through it. This creek was their water supply. Buckets were carried from it for all household needs and also to water the gardens. And, they had a path into the woods where the "out-house" was set up.¹

1. Hugo Neighborhood. 2000. *Carrol E. Brown's Hugo Memories: 1916 - 2000*. Hugo, OR.

2. Hugo Neighborhood. 2001. *Earl E. Brown's Hugo Memories: 1927 - 2000*. Hugo, OR.

The Lawrence Brown Family, Early Settlers: 1926 - 1940

1926 From May to October enough logs were cut from their woods and gathered to build a 34' by 40' two-room, two-story log home. On October 1926 neighbors came from all around to the Brown's "House Raising." They got the Browns in and roofed before November. The Brown's old log house had a lot of cedar in it. Glen McKy used his Fordson tractor to pull the logs from down in the woods. Cranking that old tractor to start its engine was terrible.¹

1927 "In 1927 - 1928 Carrol Brown's father, Lawrence, his uncle Ralph, and other adults in the community made a deal with the power company to put in a line to Hugo from above the Pirzer place (on the old stage road). The power poles were 15 - 20

feet high. Carrol still has the old spikes that they used to climb the poles with. His uncle Ralph had been a lineman and knew what to do. They salvaged all the cross irons, copper wire, and other material from an old power line that went south from Grave Creek on the east side of Mt. Sexton to Grants Pass (i.e., the Placer Divide line that came down Jack Creek to Winona). They got the materials and moved them by horse and wagon to the Hugo side and that was what they used to develop the new line."¹



Brown's Hugo Home: 1960s

Power to Hugo

1930 The older Brown kids minded the home place, took care of the garden, livestock, and the smaller kids while their mom and dad worked in the fruit industry. Lawrence also worked away from the home on the railroad and any other kind of job he could find.¹

1930 Census. Lucky Queen Precinct. Josephine County, Oregon

Lawrence E. Brown	Head	KS	1886
Emma E. Brown	Wife	CO	1891
Lenore V. Brown	Daughter	CO	1914
Carrol E. Brown	Son	CO	1916
Edwin A. Brown	Son	CO	1921
Ellen M. Brown	Daughter	CA	1924
Earl E. Brown	Son	OR	1925
Bertha E. Brown	Daughter	OR	1929

Brown Children Careers and Experiences

LeNore Brown	Music, Business, Flower Shop
Carrol Brown	Navy; Boeing; BLM Medford
Edwin Brown	
Ellen Brown	
Earl Brown	Extension Agent; Fruit Farmer
Bertha Brown	

1940 The Andrew Brown family moved to Cave Junction, Oregon.²

Want more information? Contact an officer of the *Hugo Neighborhood* on how you can become involved in your community's history and land use.

Hugo Neighborhood Association & Historical Society's Mission

This information brochure is one of a series of documents published by the Hugo Neighborhood Association & Historical Society (*Hugo Neighborhood*). It is designed to be shared with neighbors for the purpose of helping protect our rural quality of life by promoting an informed citizenry in decision-making. The *Hugo Neighborhood* is an informal nonprofit charitable and educational organization with a land use and history mission of promoting the social welfare of its neighbors.

Land Use & History

The *Hugo Neighborhood's* land use mission is to promote Oregon Statewide Goal 1 — Citizen Involvement, and to preserve, protect, and enhance the livability and economic viability of its farms, forests, and rural neighbors. It will act, if requested, as a technical resource assisting neighbors to represent themselves.

Its history mission is to educate, collect, preserve, interpret, and research its local history and to encourage public interest in the history of the Hugo area.

Volunteer membership dues are \$10.00 annually per family and normally used for paper, ink, envelopes, publications and mailings. Send us your e-mail address if you want to know what we are doing.

Email: hugo@jeffnet.org

Web Page: <http://jeffnet.org/~hugo/>

Edited by Karen Rose, Wayne McKy, & Mike Walker

HNA&HS Officers

Hal Anthony, Outreach Chair
3995 Russell Road
Grants Pass, Oregon 97526

Wayne McKy, Chair
6497 Hugo Road
Grants Pass, Oregon 97526

Mike Walker, Education Chair
3388B Merlin Rd #195
Grants Pass, Oregon 97526

Karen Rose, Web Master
575 Red Mountain Drive
Grants Pass, Oregon 97526

Not Quality Controlled, Nor Edited

LAWRENCE BROWN FAMILY: HUGO SETTLERS



Very Draft
Brochure 51 Of Hugo's Early
Settler Brochure Series

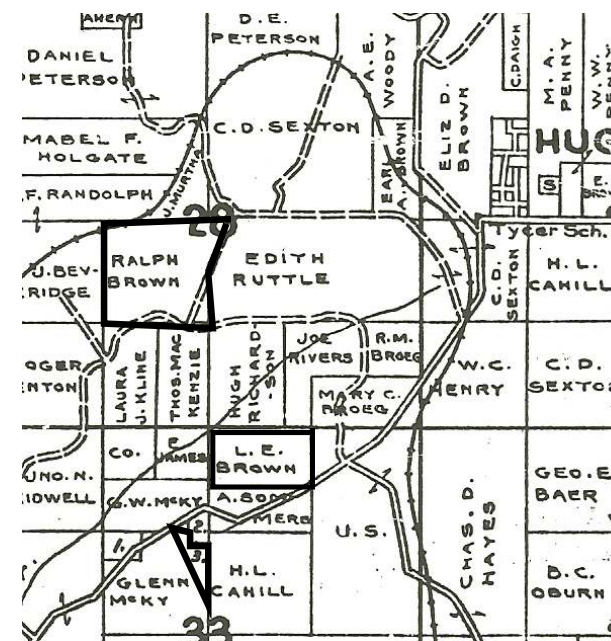

Brown's Hugo Tracts: 1932

January 19, 2008

Hugo Neighborhood Association &
Historical Society