

Edward & Ruth Neely Lead Clan Over Oregon Trail



1854 Oregon Trail The 13-member Edward and Ruth Neely family emigrated over the Oregon Trail together in 1854.¹

Edward Neely	1795 -	Driskell, Cem. OR
Ruth A. (Miller) Neely		
John Neely	1827 - 1899	Pleasant Valley Cem.
Jane Ann Neely	1828 - 1915	Sailor Cem. Noti, OR
Sarah Louisa Neely	1829 - 1863	Lane County, OR
David Neely	1832 -	Sailor Cem. Noti, OR
Edward J. Neely	1834 - 1898	Fairview Cem. OR
James Neely	1837 - 1909	Pleasant Valley Cem
Jason Neely	1840 - 1928	Eugene, OR
William Wallace Neely	1842 - 1935	Mapleton, OR
Thomas Jefferson Neely	1846 - 1920	
Benjamin F. Neely	1849 - 1866	
Mary Melvina Neely	1851 - 1870	Eugene, OR

John Neely The oldest child, John Neely, married Sarah (Taylor) Neely, born in 1828, died at age 73 in Grants Pass. They came to Oregon in 1852 (versus 1854) to Clackamas County for one year and to Lane County for 34 years and in 1887 moved to Merlin, Oregon where he resided 11 years till his death at 74 years near Tunnel No. 9.² They had six surviving children: Nancy Jane Crow, Louisa Nole, Ruth Rowe, Millie Crockett, and Edward and James Neely?.

1860 - 1865 William A. Gibson was a 26 year old farmer living in the Walker's Mill Precinct in 1860. Gibson and Elizabeth F. Vannoy married August 24, 1865 (Vol. 2, p. 79).

1870 Census. Josephine County, P.O. Slate Creek
James Neely Farm Laborer 33 years

James & Elizabeth Neely Family, Hugo Pioneers: 1870 - 1909

1870 James Neely married Mrs. Elizabeth F. Gibson July 23, 1870 (Vol. 2, p. 141). Her maiden name was Vannoy and she had been married to William A. Gibson.

1880 Census Jump Off Joe Precinct

James Neely	Farmer	43 years
Elizabeth F. Neely	Wife	35 years
Florence Neely	Dau .	6 years
Everet Neely	Son	4 years
Edward C. Neely	Son	3 years
Elmer Gibson	Step-Son	12 years

Florence married John C. Cochrane on October 11, 1893 in Josephine County. Florence died in Grants Pass July 3, 1939. John was born August 4, 1867 in Tennessee and died here in October 20, 1939. One child, Carrie E. Cochrane, was born 1894 and died 1895.²

William Wallace Neely W^M W. and Elizabeth Josephine (Fontaine) Neely lost four of their children from 1877 - 1882 at James and Elizabeth Neely's Jump Off Joe Creek Ranch: 2-year old Lela J. , 5-year old Alice, 4-year old Franklin, and 9-month old Mattie.³

1. Flora Stephenie. December 2007. *The Oregon Territory And Its Pioneers*. Web.
2. Josephine County Historical Society. 1988. *A History of Josephine County, Oregon*. pages 252 - 253. Grants Pass, OR

Pleasant Valley Cemetery (PVC)

PVC The final resting place for James and Elizabeth F. Neely, their son Everett A Neely; James' father John and his wife Sarah (Taylor) Neely; William Gibson, Elizabeth's first husband and their son, Elmer Gibson; including John, Florence and Carrie Cochrane, and many other relatives of the Neelys, was the PVC.²

1895 E. F. Neely Major Land Owner "E. F." Neely is identified on 1895 Josephine County map as the owner of almost 600 acres where the four Neely children's graves are located.⁴

1896 James Neely was one the 11 founders of the PVC Association.

1900 Census. Merlin Precinct

James Neely	Farmer	66 years
Elizabeth F. Neely	Wife	55 years

1904 Elizabeth F. Neely died November 3, 1904.

1909 James Neely died October 11, 1909 at Quartz Creek near Merlin.

Want more information? Contact an officer of the *Hugo Neighborhood* on how you can become involved in your community's history and land use.

3. Hugo Neighborhood, Josephine County Historical Society, & Rogue Advocates. 2007. *Neelys: Hugo Pioneers; Elizabeth F. Neely: Hugo Pioneer; W^M W. & E. F. Neely: Hugo Pioneers*. Hugo, OR.
4. Koch, Joseph , Draughtsman. 1895 Official Josephine County, Oregon. Map. Scale 1 inch = 1 mile. Meston - Dygert Book M'F'G. Portland, OR.

Hugo Neighborhood Association & Historical Society's Mission

This information brochure is one of a series of documents published by the Hugo Neighborhood Association & Historical Society (*Hugo Neighborhood*). It is designed to be shared with neighbors for the purpose of helping protect our rural quality of life by promoting an informed citizenry in decision-making. The *Hugo Neighborhood* is an informal nonprofit charitable and educational organization with a land use and history mission of promoting the social welfare of its neighbors.

Land Use & History

The *Hugo Neighborhood's* land use mission is to promote Oregon Statewide Goal 1 — Citizen Involvement, and to preserve, protect, and enhance the livability and economic viability of its farms, forests, and rural neighbors. It will act, if requested, as a technical resource assisting neighbors to represent themselves.

Its history mission is to educate, collect, preserve, interpret, and research its local history and to encourage public interest in the history of the Hugo area.

Volunteer membership dues are \$10.00 annually per family and normally used for paper, ink, envelopes, publications and mailings. Send us your e-mail address if you want to know what we are doing.

Email: hugo@jeffnet.org

Web Page: <http://www.hugoneighborhood.org/>

Edited by Jean Boling, Wayne McKy,

Karen Rose, & Mike Walker

HNA&HS Officers

Hal Anthony, Outreach Chair
3995 Russell Road
Grants Pass, Oregon 97526

Wayne McKy, Chair
6497 Hugo Road
Grants Pass, Oregon 97526

Karen Rose, Web Master
575 Red Mountain Drive
Grants Pass, Oregon 97526

Mike Walker, Education Chair, Hugo
Neighborhood; Director, Rogue Advocates
3388B Merlin Rd #195
Grants Pass, Oregon 97526

Josephine County Historical Society

Jean Boling, Historic Sites Chair
214 NW Booth Street
Grants Pass, Oregon 97526

NEELY FAMILY: HUGO PIONEERS

Brochure 47 in Hugo's Pioneers Brochure Series



Part of 1.5 mile Applegate Trail nomination to
Federal Register of Historic Places

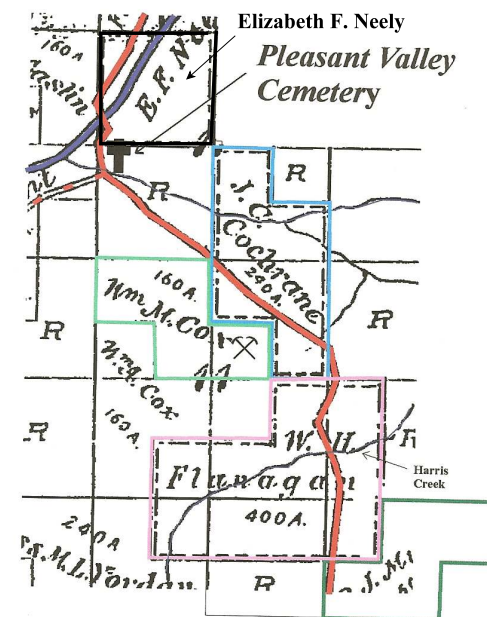

May 12, 2008

Hugo Neighborhood Association &
Historical Society
Josephine County Historical Society
Rogue Advocates

Brochure 47 in Hugo's Pioneers Brochure Series

HNA&HS 2008 - 47

C:\Documents and Settings\mike\My Documents\Genealogy\History_Brochures\People Pioneers 1800s
Quarry Section\BROCHURE_47 Neely James 051208.wpd