

Oliver & Pheobe Ward

Oliver G. Ward

Born: 1861 Iowa
 Father & Mother's Birth Place: New York

Pheobe A. Ward

Born: 1873 Kansas
 Father & Mother's Birth Place: Indiana

1885 On September 15, 1893 George T. McCormick was issued a homestead patent for 80 acres in Hugo, Oregon (Patent No. 3164).¹⁻²

1896 On September 16, 1896 John S. W. Smith was issued a homestead patent for 160 acres in Hugo, Oregon at Mt. Sexton pass (Patent No. 3749).¹⁻²

1907 The Wards had moved to the Hugo-Three Pines area in 1907 and purchased land from the McCormick family above what is now Hasis Road.³

1910 Census. Merlin Precinct, Josephine Co., OR

Oliver G. Ward	Head	IA	1861	49 yrs
Pheobe A. Ward	Wife	KS	1873	37 yrs
Wilbur Ward	Son	OR	1893	17 yrs
Nelson Ward	Son	OR	1895	15 yrs
Frank Ward	Son	OR	1898	12 yrs
Walter Ward	Son	OR	1903	7 yrs
Theodore Ward	Son	OR	1905	5 yrs
Nellie Ward	Dau	OR	1909	1 yr

Oliver was a farmer practicing general farming.

1. Bureau of Land Management (BLM), General Land Office (GLO) Records. 2007. Official Federal Land Records Site (<http://www.glorerecords.blm.gov/>). Internet.

2. Hugo Neighborhood. 2007. *Hugo Pioneers*. Map Of Federal Land Transfer in Hugo, Oregon. Hugo, OR.

The Oliver Ward Family, Hugo Settlers: 1907 - 1950

1913 Oliver Ward, of Hugo, spent Monday in the city, returning home Tuesday morning. *Rogue River Courier*. January 3, 1913. Personal And Local.

1920 There was a surprise part on Miss Iva Wright Friday evening, last. Quite a number of Three Pines people were in attendance, also Gus Springer, Miss Millicent Kiphart and Alberta Bigeman of Winona; Mrs. Allen and daughter Eva, of Grants Pass, and Frank Ward of Hugo. *Rogue River Courier*. January 30, 1920. Three Pines Weekly.

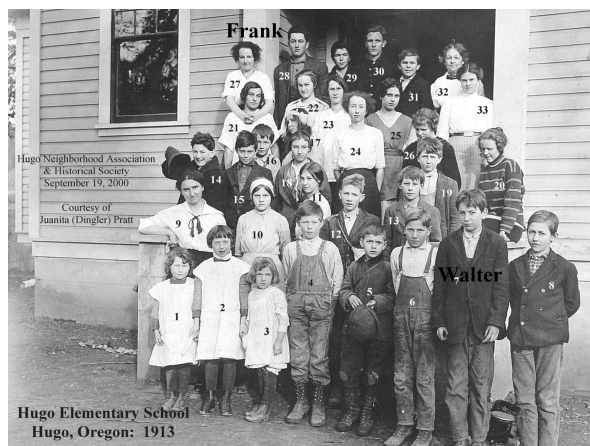

*Grades 1 - 8, Hugo Elementary School
Hugo, Oregon: 1913*

Courtesy of Juanita (Dingler) Pratt

3. Atwood, Kay. 1984. Josephine County Historical Resources Inventory: 1983 - 1984. Volume I. Grants Pass, OR.

4. Metsher, Chas. F. 1932 *Metsker Map. Josephine County, Oregon*. Portland, OR.

Farmers

1920 Census. Lucky Queen, Josephine Co., OR

Oliver Ward	Head	OH	1862	58 yrs
Pheobe Ward	Wife	CO	1873	47 yrs
Frank Ward	Son	OR	1898	22 yrs
Walter Ward	Son	OR	1903	17 yrs
Theodore Ward	Son	OR	1905	15 yrs
Nelly Ward	Dau	OR	1910	10 yrs
Elmer Ward	Son	OR	1913	7 yrs

Oliver was a farmer practicing general farming.

Peter Pirzer and Oliver Ward are driving new Fords. *Rogue River Courier*. October 1, 1920. Hugo.

1930 Census. Lucky Queen, Josephine Co., OR

Oliver G. Ward	Head	IA	1862	68 yrs
Pheobe A. Ward	Wife	KS	1873	57 yrs
Elmer Ward	Son	OR	1913	17 yrs

1932 Pheobe Ward was identified as owning the old 80 acre George McCormick homestead, and the old 160 acre John Smith homestead in 1932.⁴

1941 Oliver Ward passed September 19, 1941 in Josephine County, Oregon.

1950 Phoebe Ward passed March 5, 1950 in Josephine County, Oregon.

Want more information? Contact an officer of the *Hugo Neighborhood* on how you can become involved in your community's history and land use.

Hugo Neighborhood Association & Historical Society's Mission

This information brochure is one of a series of documents published by the Hugo Neighborhood Association & Historical Society (*Hugo Neighborhood*). It is designed to be shared with neighbors for the purpose of helping protect our rural quality of life by promoting an informed citizenry in decision-making. The *Hugo Neighborhood* is an informal nonprofit charitable and educational organization with a land use and history mission of promoting the social welfare of its neighbors.

Land Use & History

The *Hugo Neighborhood's* land use mission is to promote Oregon Statewide Goal 1 — Citizen Involvement, and to preserve, protect, and enhance the livability and economic viability of its farms, forests, and rural neighbors. It will act, if requested, as a technical resource assisting neighbors to represent themselves.

Its history mission is to educate, collect, preserve, interpret, and research its local history and to encourage public interest in the history of the Hugo area.

Volunteer membership dues are \$10.00 annually per family and normally used for paper, ink, envelopes, publications and mailings. Send us your e-mail address if you want to know what we are doing.

Email: hugo@jeffnet.org

Web Page: <http://jeffnet.org/~hugo/>

Edited by Karen Rose, Wayne McKy, & Mike Walker

HNA&HS Officers

Hal Anthony, Outreach Chair
3995 Russell Road
Grants Pass, Oregon 97526

Wayne McKy, Chair
6497 Hugo Road
Grants Pass, Oregon 97526

Mike Walker, Education Chair
3388B Merlin Rd #195
Grants Pass, Oregon 97526

Karen Rose, Web Master
575 Red Mountain Drive
Grants Pass, Oregon 97526

OLIVER WARD FAMILY: HUGO SETTLERS



Very Draft
Brochure 410 Of Hugo's Early
Settler Brochure Series

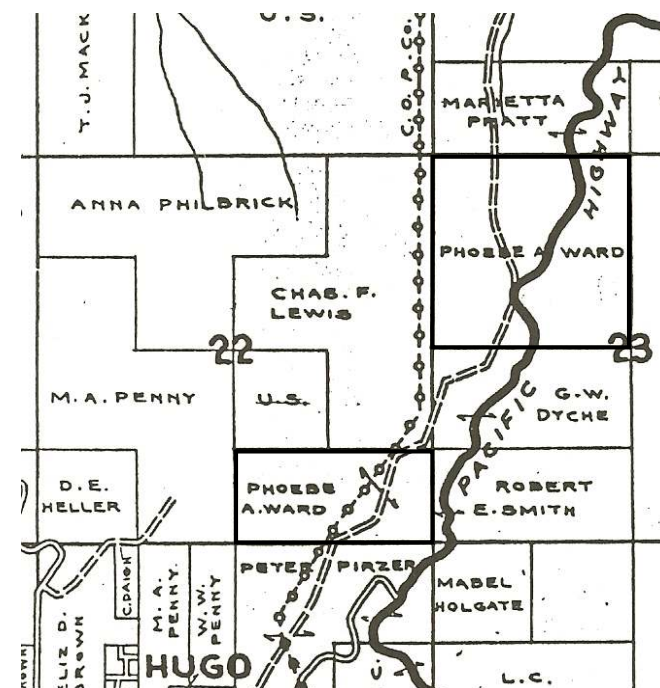

Ward's Maple Creek Acreage: 1932

February 4, 2008

Hugo Neighborhood Association &
Historical Society

Brochure 410 in Hugo's Early Settler Brochure Series
HNA&HS 2008 - 410

C:\Documents and Settings\mike\My Documents\Genealogy\History_Brochures\People Settlers 1900 - 1930s\BROCHURE_410 Ward Oliver020408.wpd

Not Quality Controlled, Nor Edited