Truman & Emma Sommers

For purposes of the Hugo's Settler brochure series, an early Hugo settler includes anyone who lived, worked, or owned property there sometime from 1900 through the 1930s.

Truman Frank Sommers

Born: July 20, 1885 Wisconsin
Death: August 24, 1957 California
Father & Mother's Birth Place: Wisconsin
Mother's Maiden Name: Campbell

Emma Sommers

Born: 1887 Wisconsin
Father's Birth Place: Norway
Mother's Birth Place: Wisconsin

1910 Census. Iola, Waupaca County, Wisconsin

Truman Sommers	Head	WI	1886	24 yrs
Emma Sommers	Wife	WI	1887	23 yrs

Truman's occupation was a laborer in a saw mill.

1917 - 1918 World War I Draft Registration Card

Truman Frank Sommers

Residence: Waupaca County, Wisconsin
Born: July 20, 1885

1920 Census

The Truman Sommers Family, Hugo Settlers: ca., 1928 - 1935

1928 - Sommers Moved To Hugo Maude and Andy Sommers and their sons, two-year old Clarence and 11-year old Eugene, moved to Hugo, Oregon in 1928. Truman, brother to Andy, and Emma Truman eventually also moved to Hugo to a location near the Southern Pacific Railroad's section house.

1930 Census. Lucky Queen Precinct, Josephine County, Oregon

Andrew T. Sommers	Head	WI	1891	39 yrs
Mand A. Sommers	Wife	WI	1892	38 yrs
Clarance Sommers	Son	MT	1917	13 yrs
Truman Sommers	Brother	WI	1886	44 yrs
Emma Sommers	Sister-in-law	WI	1887	43 yrs
Eugene Sommers	Nephew	WA	1926	3 yrs

Andrew and Truman Sommers are brothers.
Andrew's occupation was farming a farm he owned.

Truman's occupation was mining in a gold mine.

1. Hugo Neighborhood. 2000. *June Ione (Sommers) Miksik's Hugo Memories: 1932 - 2000*. Hugo, OR.

2. Metsher, Chas. F. 1932 *Metsker Map. Josephine County, Oregon*. Portland, OR.

3. Oregon Death Index, 1903-98. Internet.

4. California Death Index, 1940 - 1997. Internet.

5. Internet.net. October 22, 2007. *Pleasant Valley Cemetery, Hugo, Josephine County, Oregon*. Contributed by Jean Boling.

Gold Miner

1932 In 1932 Andrew Sommers had a 10 acre farm.²

In 1932 a T. Sommers had 40 acres high up in the Grave Creek Hills on the Ahern Road.² This property is referenced in June Sommers' oral history.¹

"The Sommers family also owned a new cabin somewhere on a road that circled around back of Hugo."

1935 Forty-eight year old Emma Sommers passed June 7, 1935 in Josephine County, Oregon.³

1957 Seventy year old Truman Frank Sommers passed August 24, 1957 in San Bernadino, California, the same place his brother, Andrew, died.⁴ He was taken back to Oregon and the Pleasant Valley Cemetery to rest besides his wife Emma.

Pleasant Valley Cemetery⁵

Sommers, Emma d. 6/7/1935
Sommers, Truman b. 7/20/1885 d. 8/1957

Truman and Emma Sommers share a tombstone in the Pleasant Valley Cemetery.

Want more information? Contact an officer of the *Hugo Neighborhood* on how you can become involved in your community's history and land use.

Hugo Neighborhood Association & Historical Society's Mission

This information brochure is one of a series of documents published by the Hugo Neighborhood Association & Historical Society (*Hugo Neighborhood*). It is designed to be shared with neighbors for the purpose of helping protect our rural quality of life by promoting an informed citizenry in decision-making. The *Hugo Neighborhood* is an informal nonprofit charitable and educational organization with a land use and history mission of promoting the social welfare of its neighbors.

Land Use & History

The *Hugo Neighborhood's* land use mission is to promote Oregon Statewide Goal 1 — Citizen Involvement, and to preserve, protect, and enhance the livability and economic viability of its farms, forests, and rural neighbors. It will act, if requested, as a technical resource assisting neighbors to represent themselves.

Its history mission is to educate, collect, preserve, interpret, and research its local history and to encourage public interest in the history of the Hugo area.

Volunteer membership dues are \$10.00 annually per family and normally used for paper, ink, envelopes, publications and mailings. Send us your e-mail address if you want to know what we are doing.

Email: hugo@jeffnet.org

Web Page: <http://jeffnet.org/~hugo/>

Edited by Karen Rose, Wayne McKy, & Mike Walker

HNA&HS Officers

Hal Anthony, Outreach Chair
3995 Russell Road
Grants Pass, Oregon 97526

Wayne McKy, Chair
6497 Hugo Road
Grants Pass, Oregon 97526

Mike Walker, Education Chair
3388B Merlin Rd #195
Grants Pass, Oregon 97526

Karen Rose, Web Master
575 Red Mountain Drive
Grants Pass, Oregon 97526

Not Quality Controlled, Nor Edited

TRUMAN SOMMERS FAMILY: HUGO SETTLERS



Very Draft
Brochure 378 Of Hugo's Early
Settler Brochure Series

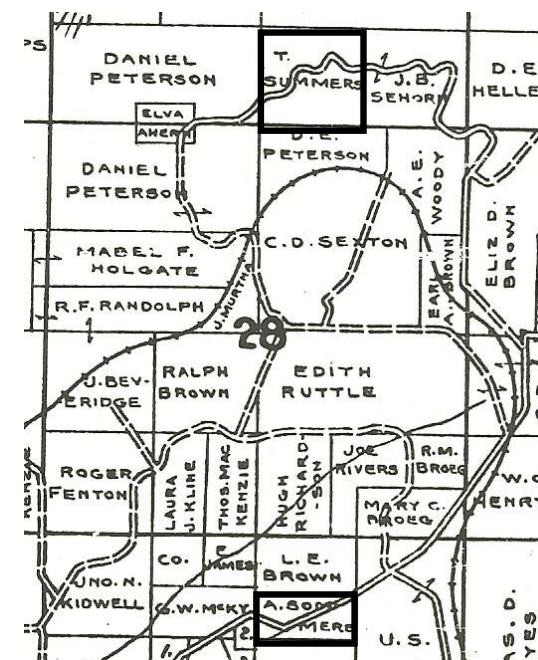

Sommers' Hugo Tracts: 1932

February 13, 2008

Hugo Neighborhood Association &
Historical Society

Brochure 378 in Hugo's Early Settler Brochure Series
HNA&HS 2008 - 378

C:\Documents and Settings\mike\My Documents\Genealogy\History_Brochures\People Settlers 1900 -
1930s\BROCHURE_378 Sommers Truman 012608.wpd