

William & Fanny Hefling

Coleman M. Hefling

Born: 1837 Kentucky
Died: May 2, 1900 Josephine Co., OR

Eliza Jane Hefling

Born: April 11, 1848 Kentucky
Died: May 2, 1900 Josephine Co., OR

1860 Census. Rowan County, Kentucky

Coleman M. Hefling	Male	KY	1837	23 yrs
Eliza Jane Hefling	Female	KY	1842	18 yrs
Sara F. Hefling	Female	KY	1860	1 yr
Anjelico Blue	Female	KY	1796	64 yrs
? William Hefling	Son	KY	1868	

A working hypothesis is that William is a son of Coleman and Eliza Hefling.

1895 A Col. Hefling is identified as owning 160 acres on the Oregon & California Railroad in Hugo, Oregon two miles north of Merlin.³

1896 Josephine County Homestead On

May 22, 1896 Coleman Hefling was issued a homestead patent for 160 acres in Hugo, Oregon (Patent No. 3733).^{2,3} The land is on both sides of the old Southern Pacific Railroad tracks.



1900 Census. Merlin Precinct, Josephine Co., OR

William M. Hefling	Head	KY	1868	32 yrs
Fanny K. Hefling	Wife	Canada	1877	23 yrs
Grace J. Hefling	Dau	OR	1898	1 yr
Blanche C. Hefling	Dau	OR	1899	1 yr

William was a farmer.

The William Hefling Family, Hugo Pioneers: ca., 1890s - 1910s

1901 Mr. Hefling's mill is progressing fast. *Rogue River Courier*. March 2, 1901. Hugo Items. Mr. Hefling's mill is running. The lumber is first class and the boarding house too. All the farmers have planted extra large gardens to supply it this summer. Hugo is daily improving. *Rogue River Courier*. May 2, 1901. Hugo Items. Those wishing a good meal, will do well to stop at **Yancey Hotel** at Mr. Hefling's mill. The lumber is first class and the mill too. *Rogue River Courier*. May 16, 1901. Hugo Items. Mr. Tolson, our section foreman, with the aid of his men, is putting in a spur at Hugo for the convenience of Mr. Hefling in shipping his lumber. *Rogue River Courier*. August 1, 1901. Hugo Items. Mr. Hefling is still shipping lumber from Hugo Dick. *Rogue River Courier*. October 24, 1901. Hugo Items. The Hefling Mill has shut down, and they are now moving it to Quartz Creek. By Dick *Rogue River Courier*. September 19, 1901. Hugo Items. The Hefling mill has gone to Quartz Creek, all except the old boiler. Mr. Jones runs the boarding house. We miss the whistle, calling time to work and time to play. By Dick *Rogue River Courier*. October 3, 1901. Hugo Items.

The Hefling mill has gone to Quartz Creek.

1901 Mrs. **Ella Yancey** has been visiting her parents at the Hefling Mill for the past week. Mr. Yancey and Miss Ethel came home from the Good Samaritan hospital Thursday. Her health has improved greatly and her friends greet her with joy. By Dick *Rogue River Courier*. September 19, 1901. Hugo Items. **W. M. Heflinger's** sawmill has started up and is cutting 30,000 feet of lumber per day. A number of teams are hauling lumber to Hugo to be shipped to the Sugar Pine, Door & Lumber Company at Grants Pass. By Dick. *Rogue River Courier*. May 15, 1902. Hugo Items.

W. A. Hefling's Sawmill

1902 The weather at Hugo is extremely balmy. Gardens are backward. Loading cars daily with lumber from Hefling's mill, which is still running. *Rogue River Courier*. June 19, 1902. Hugo Items.

1911 William and Fannie Hefling appear in the 1911 census of Canada in Alberta.

1920 Census. Seattle, King Co., Washington

William M. Hefling	Head	KY	1869	51 yrs
Fanny Hefling	Wife	Canada	1878	42 yrs
Harry L. Hefling	Son	OR	1902	18 yrs
Ruth Hefling	Da.	OR	1905	15 yrs

William was a laborer farming.

1932 & 1955 Hefling Community The community of Hefling is identified on the 1932 and 1955 Metsker maps.

Pleasant Valley Cemetery⁵⁻⁶

Hefling, Carrie Blanche	b. 12/4/1898	d. 12/11/1900
Hefling Coleman	b.	d. 5/2/1900
Hefling, Mrs. E(liza) J(ane)b.	4/11/1848	d. 1/24/1915

Want more information? Contact an officer of the *Hugo Neighborhood* on how you can become involved in your community's history and land use.

1. Koch, Joseph, Draughtsman. 1895 Official Josephine County, Oregon. Map. Scale 1 inch = 1 mile. Meston - Dygert Book M'F'G. Portland, OR.
2. Bureau of Land Management (BLM), General Land Office (GLO) Records, 2007. Official Federal Land Records Site (<http://www.glorerecords.blm.gov/>). Internet.
3. Hugo Neighborhood. 2007. *Hugo Pioneers*. Map Of Federal Land Transfer in Hugo, Oregon. Hugo, OR.
4. Internet. 2007. Pleasant Valley Cemetery, Hugo, Josephine County, Oregon. *List of folks at Pleasant Valley Cemetery*. Inernet.
5. Internet.net. October 22, 2007. *Pleasant Valley Cemetery, Hugo, Josephine County, Oregon*. Contributed by Jean Boling.
6. Oregon Death Index, 1903-98. Internet.

Hugo Neighborhood Association & Historical Society's Mission

This information brochure is one of a series of documents published by the Hugo Neighborhood Association & Historical Society (*Hugo Neighborhood*). It is designed to be shared with neighbors for the purpose of helping protect our rural quality of life by promoting an informed citizenry in decision-making. The *Hugo Neighborhood* is an informal nonprofit charitable and educational organization with a land use and history mission of promoting the social welfare of its neighbors.

Land Use & History

The *Hugo Neighborhood's* land use mission is to promote Oregon Statewide Goal 1 — Citizen Involvement, and to preserve, protect, and enhance the livability and economic viability of its farms, forests, and rural neighbors. It will act, if requested, as a technical resource assisting neighbors to represent themselves.

Its history mission is to educate, collect, preserve, interpret, and research its local history and to encourage public interest in the history of the Hugo area.

Volunteer membership dues are \$10.00 annually per family and normally used for paper, ink, envelopes, publications and mailings. Send us your e-mail address if you want to know what we are doing.

Email: hugo@jeffnet.org

Web Page: <http://www.hugoneighborhood.org/>

Edited by Jean Boling, Karen Rose,

Wayne McKy, & Mike Walker

HNA&HS Officers

Wayne McKy, Chair
6497 Hugo Road
Grants Pass, Oregon 97526

Mike Walker, Education Chair
3388B Merlin Rd #195
Grants Pass, Oregon 97526

Web Master

Karen Rose, Web Master
575 Red Mountain Drive
Grants Pass, Oregon 97526

Josephine County Historical Society

Jean Boling, Historic Sites Chair
Josephine County Historical Society
124 NW Booth Street
Grants Pass, Oregon 97526

Not Quality Controlled, Nor Edited

WILLIAM HEFLING FAMILY: HUGO PIONEERS

Draft

Brochure 32B in Hugo's Pioneers Brochure Series

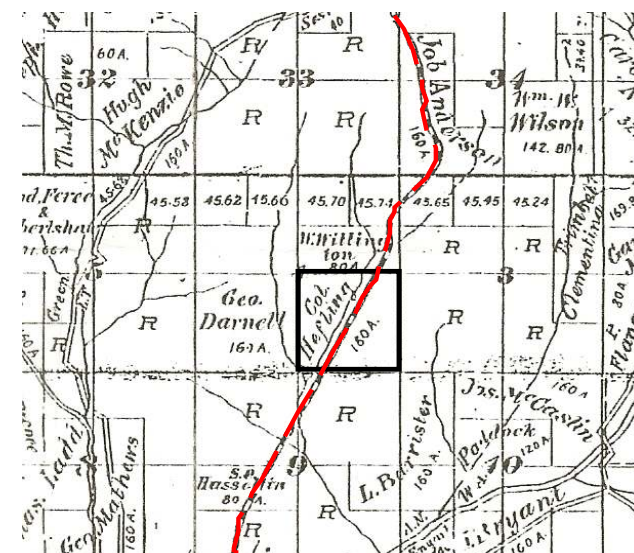

Coleman Hefling's Hugo Homestead: 1895

June 9, 2008
Updated July 3, 2011

Hugo Neighborhood Association &
Historical Society
Josephine County Historical Society

Brochure 32B in Hugo's Pioneers Brochure Series
HNA&HS 2008/2011 - 32B

C:\Documents and Settings\mike\My Documents\Genealogy\History_Brochures\People Pioneers
1800s\BROCHURE_32B Hefling Coleman 060908.wpd