

## Coleman & Eliza Hefling

### Coleman M. Hefling

Born: 1837 Kentucky  
Died: May 2, 1900 Josephine Co., OR

### Eliza Jane Hefling

Born: April 11, 1848 Kentucky  
Died: May 2, 1900 Josephine Co., OR

### 1850 Census. Fleming County, Kentucky

Coleman M. Hefling Male KY 1838 12 yrs

### 1860 Census. Rowan County, Kentucky

Coleman M. Hefling Male KY 1837 23 yrs  
Eliza Jane Hefling Female KY 1842 18 yrs  
Sara F. Hefling Female KY 1860 1 yr  
Anjelico Blue Female KY 1796 64 yrs  
? William Hefling Son KY 1868  
? Tott Hefling Son OH 1877

A working hypothesis is that William and Tott are sons of Coleman and Eliza Hefling.

**1861 - 1863: Civil War** Coleman Hefling's regiment was with the Union: 24<sup>th</sup> Regiment, Kentucky Infantry, Company F.<sup>1</sup> - Enlisted as a Private October 8, 1861 at Lexington, Kentucky. Enlisted in on December 31, 1861. Deserted from on April 10, 1863.<sup>2</sup>

### 1870 Census? - 1880 Census?

1. Ancestry.com. February 22, 2008. *U.S. Civil War Soldiers, 1861-1865*. Internet.

2. Ancestry.com. February 22, 2008. *American Civil War Soldiers*. Internet.

3. Koch, Joseph, Draughtsman. 1895 Official Josephine County, Oregon. Map. Scale 1 inch = 1 mile. Meston - Dygert Book M'F'G. Portland, OR.

## The Coleman Hefling Family, Hugo Pioneers: ca., 1890s - 1915

**1895** A Col. Hefling is identified as owning 160 acres on the Oregon & California Railroad in Hugo, Oregon two miles north of Merlin.<sup>3</sup>

### 1896 Josephine County

**Homestead** On May 22, 1896 Coleman Hefling was issued a homestead patent for 160 acres in Hugo, Oregon (Patent No. 3733).<sup>4-5</sup> The land is on both sides of the old Southern Pacific Railroad tracks.



### 1900 Census. Merlin Precinct, Josephine Co., OR

William M. Hefling Head KY 1868 32 yrs  
Fanny K. Hefling Wife Canada 1877 23 yrs  
Grace J. Hefling Dau OR 1898 1 yr  
Blanche C. Hefling Dau OR 1899 1 yr

William was a laborer farming.

### 1900 Census. Merlin Precinct, Josephine Co., OR

Tott. Hefling Head OH 1877 25 yrs  
Effie M. Hefling Wife OR 1878 22 yrs

Tott was a farmer.

**1900 Pleasant Valley Cemetery** Coleman Hefling died May 2, 1900, aged 63 years. Carrie Blanche Hefling died December 12, 1900.<sup>6</sup>

4. Bureau of Land Management (BLM), General Land Office (GLO) Records. 2007. Official Federal Land Records Site. Internet.

5. Hugo Neighborhood. 2007. *Hugo Pioneers*. Map Of Federal Land Transfer in Hugo, Oregon. Hugo, OR.

6. Internet.net. October 22, 2007. *Pleasant Valley Cemetery, Hugo, Josephine County, Oregon*. Contributed by Jean Boling.

## Federal Census

### 1900 Census. ?

### 1910 Census. Merlin Precinct, Josephine Co., OR

Mrs. J. Hefling Widow KY 1842 68 yrs

**1915 Pleasant Valley Cemetery** Mrs E. J. Hefling [Mr. Eliza Jane Hefling<sup>7</sup>] died January 24, 1915, aged 66 years.

### 1920 Census. Seattle, King Co., Washington

William M. Hefling Head KY 1869 51 yrs  
Fanny Hefling Wife Canada 1878 42 yrs  
Harry L. Hefling Son OR 1902 18 yrs  
Ruth Hefling Son OR 1905 15 yrs

William was a laborer farming.

**1935** William Hefling passed April 7, 1935 in Marion County, Oregon.<sup>7</sup>

**1932 & 1955 Hefling Community** The community of Hefling is identified on the 1932 and 1955 Metsker maps along the Southern Pacific Railroad.<sup>8</sup>

### Pleasant Valley Cemetery<sup>6</sup>

Hefling, Carrie Blanche b. 12/4/1898 d. 12/11/1900  
Hefling Coleman b. d. 5/2/1900  
Hefling, Mrs. E(liza) J(ane) b. 4/11/1848 d. 1/24/1915

**Want more information?** Contact an officer of the *Hugo Neighborhood* on how you can become involved in your community's history and land use.

7. Oregon Death Index, 1903-98. Internet.

8. Metsker, Chas. F. 1932 *Metsker Map. Josephine County, Oregon*. Portland, OR; and Metsker, Chas. F. 1955 *Metsker Map. Josephine County, Oregon*. Portland, OR.

## Hugo Neighborhood Association & Historical Society's Mission

This information brochure is one of a series of documents published by the Hugo Neighborhood Association & Historical Society (*Hugo Neighborhood*). It is designed to be shared with neighbors for the purpose of helping protect our rural quality of life by promoting an informed citizenry in decision-making. The *Hugo Neighborhood* is an informal nonprofit charitable and educational organization with a land use and history mission of promoting the social welfare of its neighbors.

### Land Use & History

The *Hugo Neighborhood's* land use mission is to promote Oregon Statewide Goal 1 — Citizen Involvement, and to preserve, protect, and enhance the livability and economic viability of its farms, forests, and rural neighbors. It will act, if requested, as a technical resource assisting neighbors to represent themselves.

Its history mission is to educate, collect, preserve, interpret, and research its local history and to encourage public interest in the history of the Hugo area.

Volunteer membership dues are \$10.00 annually per family and normally used for paper, ink, envelopes, publications and mailings. Send us your e-mail address if you want to know what we are doing.

Email: [hugo@jeffnet.org](mailto:hugo@jeffnet.org)

Web Page: <http://www.hugoneighborhood.org/>

Edited by Jean Boling, Karen Rose,

Wayne McKy, & Mike Walker

### HNA&HS Officers

Wayne McKy, Chair  
6497 Hugo Road  
Grants Pass, Oregon 97526

Mike Walker, Education Chair  
3388B Merlin Rd #195  
Grants Pass, Oregon 97526

### Web Master

Karen Rose, Web Master  
575 Red Mountain Drive  
Grants Pass, Oregon 97526

### Josephine County Historical Society

Jean Boling, Historic Sites Chair  
Josephine County Historical Society  
124 NW Booth Street  
Grants Pass, Oregon 97526

Not Quality Controlled, Nor Edited

# COLEMAN HEFLING FAMILY: FEDERAL CENSUS

Very Draft

Brochure 32A in Hugo's Pioneers Brochure Series

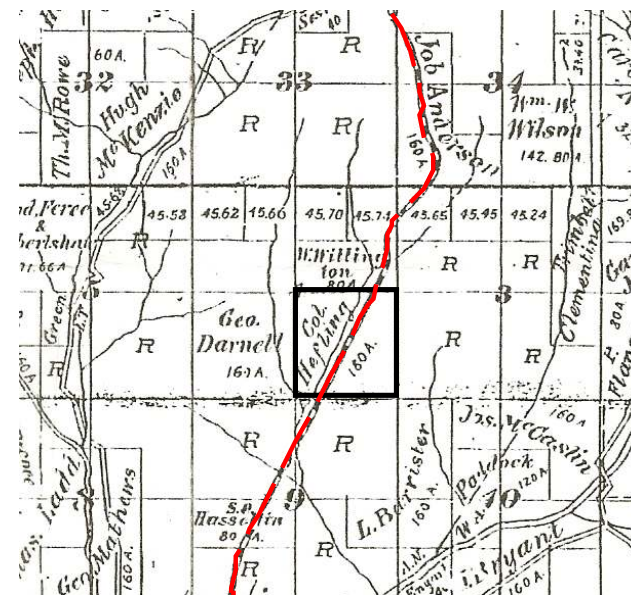

Coleman Hefling's Homestead: 1895

February 23, 2008

Hugo Neighborhood Association &  
Historical Society  
Josephine County Historical Society

Brochure 32A in Hugo's Pioneers Brochure Series -  
HNA & HS 2008/2011 - 32A

C:\Documents and Settings\mike\My Documents\Genealogy\History\_Brochures\People Pioneers  
1800s\BROCHURE\_32A Hefling Census 022208.wpd