Hugo's Early Settlers

For purposes of the Hugo's Settler brochure series, an early Hugo settler includes anyone who lived, worked, or owned property there sometime from 1900 through the 1930s.

Troy A. Phipps

Born:
Birth Place:
Father's Birth Place:
Mother's Birth Place:

??

Born:
Birth Place:
Father's Birth Place:
Mother's Birth Place:

A Troy A. Phipps lived in the Ashland Precinct, Jackson County, Oregon in 1920. A Troy A. Phipps lived in the Portland Precinct, Multnomah, Oregon in 1930. Unknown whether one of these men is our Troy A. Phipps.

[Simple ancestry search for Josephine County, Oregon 1920 & 1930 1/25/08](#)

Troy A Phipps Family, Early Hugo Settler Family: ca., 1930s??

1901 Albert Osborn's Hugo Homestead On May 8, 1901 Albert H. Osborn was issued a homestead certificate for 160 acres in Hugo, Oregon (Patent No. 5091).¹⁻²

The Osborn homestead was an important tract from the early 1880s through the early 1910s as the central location of the railroad in building and maintaining Tunnel No. 9.

Tunnel No. 9 Tract

1932 Troy A. Phipps was in possession of the Osborn's Tunnel No. 9 homestead in 1932.³

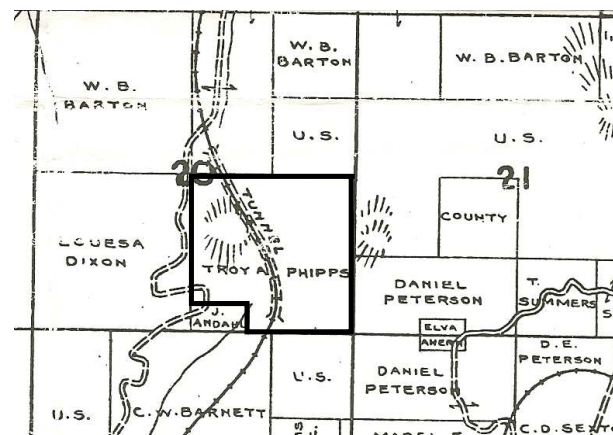

Troy A. Phipps' Tunnel No. 9 Tract: 1932

Want more information? Contact an officer of the *Hugo Neighborhood* on how you can become involved in your community's history and land use.

1. Bureau of Land Management (BLM), General Land Office (GLO) Records. 2007. Official Federal Land Records Site (<http://www.glorerecords.blm.gov/>). Internet.
2. Hugo Neighborhood. 2007. *Hugo Pioneers*. Map Of Federal Land Transfer in Hugo, Oregon. Hugo, OR.
3. Metsker, Chas. F. 1932 *Metsker Map. Josephine County, Oregon*. Portland, OR.

Hugo Neighborhood Association & Historical Society's Mission

This information brochure is one of a series of documents published by the Hugo Neighborhood Association & Historical Society (*Hugo Neighborhood*). It is designed to be shared with neighbors for the purpose of helping protect our rural quality of life by promoting an informed citizenry in decision-making. The *Hugo Neighborhood* is an informal nonprofit charitable and educational organization with a land use and history mission of promoting the social welfare of its neighbors.

Land Use & History

The *Hugo Neighborhood's* land use mission is to promote Oregon Statewide Goal 1 — Citizen Involvement, and to preserve, protect, and enhance the livability and economic viability of its farms, forests, and rural neighbors. It will act, if requested, as a technical resource assisting neighbors to represent themselves.

Its history mission is to educate, collect, preserve, interpret, and research its local history and to encourage public interest in the history of the Hugo area.

Volunteer membership dues are \$10.00 annually per family and normally used for paper, ink, envelopes, publications and mailings. Send us your e-mail address if you want to know what we are doing.

Email: hugo@jeffnet.org

Web Page: <http://jeffnet.org/~hugo/>

Edited by Karen Rose, Wayne McKy, & Mike Walker

HNA&HS Officers

Hal Anthony, Outreach Chair
3995 Russell Road
Grants Pass, Oregon 97526

Wayne McKy, Chair
6497 Hugo Road
Grants Pass, Oregon 97526

Mike Walker, Education Chair
3388B Merlin Rd #195
Grants Pass, Oregon 97526

Karen Rose, Web Master
575 Red Mountain Drive
Grants Pass, Oregon 97526

TROY PHIPPS FAMILY: HUGO SETTLERS



Very Draft
Brochure 320 Of Hugo's Early Settler Brochure Series

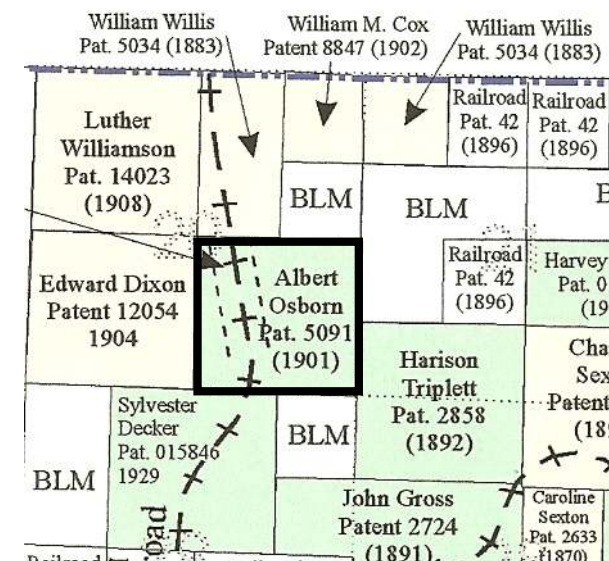

*Albert Osborn's Hugo Homestead: 1901
Troy Phipps Would Own It in 1932*

Not Quality Controlled, Nor Edited

February 1, 2008

Hugo Neighborhood Association & Historical Society

Brochure 320 in Hugo's Early Settler Brochure Series
HNA&HS 2008 - 320

C:\Documents and Settings\mike\My Documents\Genealogy\History_Brochures\People Settlers 1900 - 1930s\BROCHURE_320 Phipps Troy 020108.wpd