

Thomas Mackenzie, Hugo's Early Settler

Thomas L. Mackenzie

Born: 1870 Scotland
 Father & Mother's Birth Place: Scotland

Anna Mackenzie

Born: 1873 Canada

Hugo Mackenzies Born Died

Christina Ross [Mackenzie] Tullis	1862	1949
Thomas Shand Mackenzie	1869	1941
Annie M. Mackenzie	1870	1963
Lily Mackenzie	1872	1947
William Mackenzie (husband)	1875	1967
Agnes Macrae Mackenzie (wife)	1895	1959

1913 W. McKenzie, our prominent merchant, spent Easter with friends in Gold Hill. *Rogue River Courier*. April 4, 1913. [Hugo Items](#).

1920 Census. Minneapolis Ward 5, Hennepin, Minnesota

Thomas L. MacKenzie	Head	Scotland	1870	50yrs
Anna MacKenzie	Wife	Canada	1873	47yrs

1930 Census. Lucky Queen Precinct, Josephine County, Oregon

Thomas Mackenzie	Head	Scotland	1870	60 yrs
Annie N. Mackenzie	Sister	Scotland	1872	58 yrs
Lilias Mackenzie	Sister	Scotland	1875	55 yrs
Chistiania R. Tullis	Sister	Scotland	1860	70 yrs
William M. Tullis	Nephew	Scotland	1890	40 yrs

The Thomas McKenzie Family, A Hugo Settler Family: 1920s?? - 1941

1930 Thomas' occupation was farming owning his own farm. William's occupation was civil engineer.

1930 Census. Lucky Queen Precinct, Josephine County, Oregon

William Mackenzie Head Scotland 1876 44 yrs

William's occupation was merchant of general store.

1932 Thomas Mackenzie was living at his Hugo fruit farm south and adjacent to the Jennie Beveridge fruit farm.¹

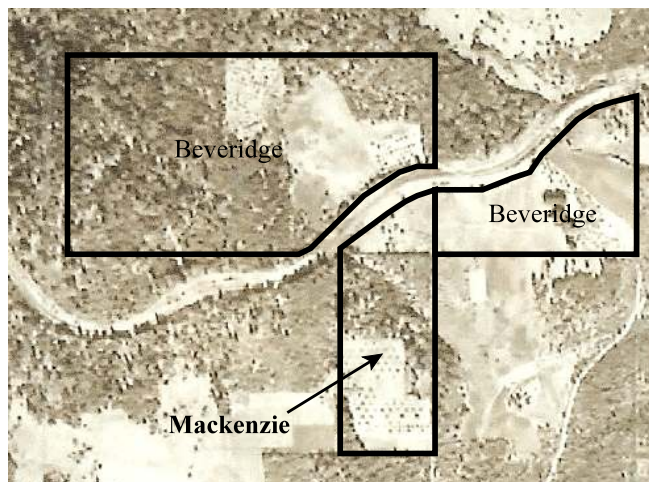

Mackenzie's Hugo Walnut Farm: 1939

Walnut Farm

1940 The teacherage on the school property was repaired and remodeled during the summer. Thomas MacKenzie was elected school director of the Hugo district for three years. D. E. Heller was elected clerk.²

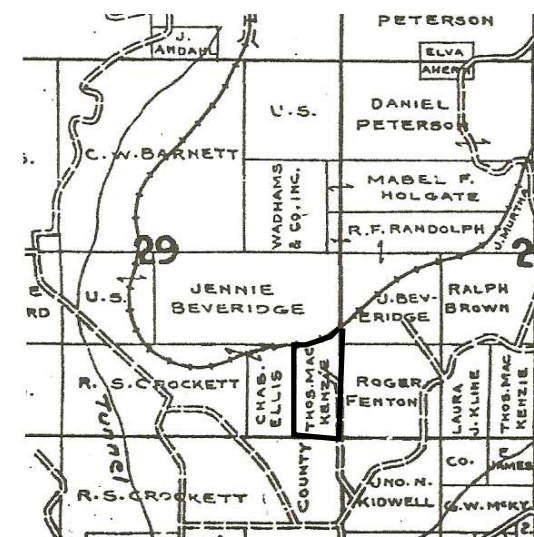

Thomas Mackenzie's Walnut Farm: 1932

Want more information? Contact an officer of the *Hugo Neighborhood* on how you can become involved in your community's history and land use.

1. Metsker, Chas. F. *1932 Metsker Map. Josephine County, Oregon*. Portland, OR.

2. Hugo Neighborhood. 2001. *Draft - Beatrice June (Decker) Bentson's Hugo Memories: 1924 - 2001*. Hugo, OR.

Hugo Neighborhood Association & Historical Society's Mission

This information brochure is one of a series of documents published by the Hugo Neighborhood Association & Historical Society (*Hugo Neighborhood*). It is designed to be shared with neighbors for the purpose of helping protect our rural quality of life by promoting an informed citizenry in decision-making. The *Hugo Neighborhood* is an informal nonprofit charitable and educational organization with a land use and history mission of promoting the social welfare of its neighbors.

Land Use & History

The *Hugo Neighborhood's* land use mission is to promote Oregon Statewide Goal 1 — Citizen Involvement, and to preserve, protect, and enhance the livability and economic viability of its farms, forests, and rural neighbors. It will act, if requested, as a technical resource assisting neighbors to represent themselves.

Its history mission is to educate, collect, preserve, interpret, and research its local history and to encourage public interest in the history of the Hugo area.

Volunteer membership dues are \$10.00 annually per family and normally used for paper, ink, envelopes, publications and mailings. Send us your e-mail address if you want to know what we are doing.

Email: hugo@jeffnet.org

Web Page: <http://jeffnet.org/~hugo/>

Edited by Jacaue Hardwick, Karen Rose,
Wayne and Janet McKy, & Mike Walker

HNA&HS Officers

Hal Anthony, Outreach Chair
3995 Russell Road
Grants Pass, Oregon 97526

Wayne McKy, Chair
6497 Hugo Road
Grants Pass, Oregon 97526

Mike Walker, Education Chair
3388B Merlin Rd #195
Grants Pass, Oregon 97526

Karen Rose, Web Master
575 Red Mountain Drive
Grants Pass, Oregon 97526

Not Quality Controlled, Nor Edited

THOMAS MACKENZIE FAMILY: HUGO SETTLERS



Very Draft
Brochure 274 Of Hugo's Early
Settler Brochure Series

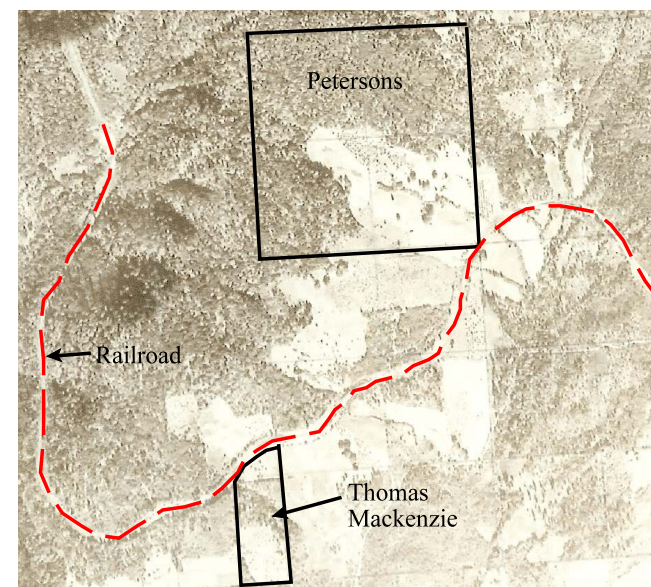

Thomas MacKenzie's Hugo Farm: 1939

April 20, 2009

**Hugo Neighborhood Association &
Historical Society**

Brochure 274 in Hugo's Early Settler Brochure Series
HNA & HS 2009 -274

C:\Documents and Settings\mike\My Documents\Genealogy\History_Brochures\People Settlers 1900 -
1930s\BROCHURE_274 McKenzie Thomas 042109.wpd