

## Hugo's Early Settlers

For purposes of the Hugo's Settler brochure series, an early Hugo settler includes anyone who lived, worked, or owned property there sometime from 1900 through the 1930s.

??

Born:

Birth Place:

Father's Birth Place:

Mother's Birth Place:

??

Born:

Birth Place:

Father's Birth Place:

Mother's Birth Place:

Simple ancestry search for Josephine County, Oregon  
1930 1/26/08

## H. M. Bateman, Hugo Settler Family: 19?? - 19??

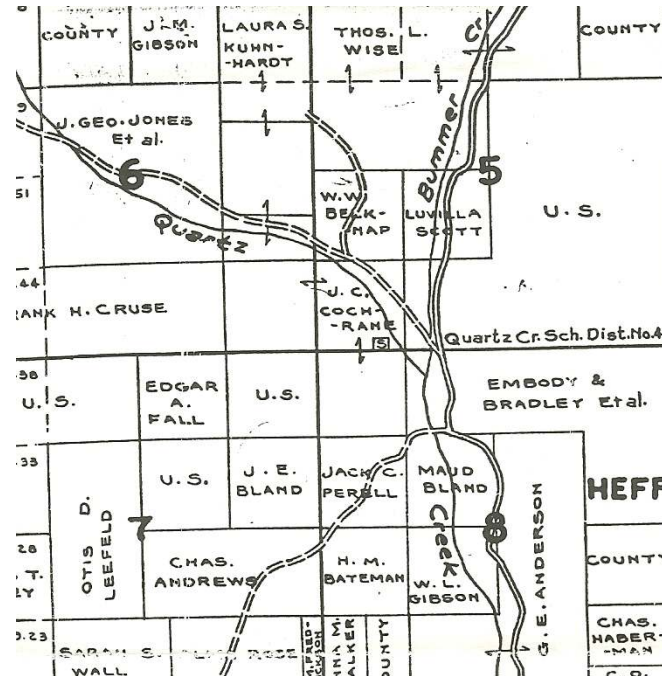

## Bummer & Quartz Creeks Confluence

**Want more information?** Contact an officer of the *Hugo Neighborhood* on how you can become involved in your community's history and land use.

1. Bureau of Land Management (BLM), General Land Office (GLO) Records. 2007. Official Federal Land Records Site (<http://www.glorerecords.blm.gov/>). Internet.
2. Hugo Neighborhood. 2007. *Hugo Pioneers*. Map Of Federal Land Transfer in Hugo, Oregon. Hugo, OR.
3. Metscher, Chas. F. 1932 *Metsker Map*. Josephine County, Oregon. Portland, OR.

---

---

## Hugo Neighborhood Association & Historical Society's Mission

This information brochure is one of a series of documents published by the Hugo Neighborhood Association & Historical Society (*Hugo Neighborhood*). It is designed to be shared with neighbors for the purpose of helping protect our rural quality of life by promoting an informed citizenry in decision-making. The *Hugo Neighborhood* is an informal nonprofit charitable and educational organization with a land use and history mission of promoting the social welfare of its neighbors.

### Land Use & History

The *Hugo Neighborhood's* land use mission is to promote Oregon Statewide Goal 1 — Citizen Involvement, and to preserve, protect, and enhance the livability and economic viability of its farms, forests, and rural neighbors. It will act, if requested, as a technical resource assisting neighbors to represent themselves.

Its history mission is to educate, collect, preserve, interpret, and research its local history and to encourage public interest in the history of the Hugo area.

Volunteer membership dues are \$10.00 annually per family and normally used for paper, ink, envelopes, publications and mailings. Send us your e-mail address if you want to know what we are doing.

Email: [hugo@jeffnet.org](mailto:hugo@jeffnet.org)  
Web Page: <http://jeffnet.org/~hugo/>  
Edited by Karen Rose, Wayne McKy, & Mike Walker

---

---

### HNA&HS Officers

Hal Anthony, Outreach Chair  
3995 Russell Road  
Grants Pass, Oregon 97526

Wayne McKy, Chair  
6497 Hugo Road  
Grants Pass, Oregon 97526

Mike Walker, Education Chair  
3388B Merlin Rd #195  
Grants Pass, Oregon 97526

Karen Rose, Web Master  
575 Red Mountain Drive  
Grants Pass, Oregon 97526

**Not Quality Controlled, Nor Edited**

Brochure 25 in Hugo's Early Settler Brochure Series  
HNA & HS 2008 - 25  
C:\Documents and Settings\mike\My Documents\Genealogy\History\_Brochures\People Settlers 1900 -  
1930s\BROCHURE\_25 Bateman 012608.wpd

---

---

# H. M. BATEMAN FAMILY: HUGO SETTLERS



**Very Draft**  
Brochure 25 Of Hugo's Early  
Settler Brochure Series



**January 26, 2008**

**Hugo Neighborhood Association &  
Historical Society**