

---

---

## Hugo's Early Settlers

For purposes of the Hugo's Settler brochure series, an early Hugo settler includes anyone who lived there from 1900 through 1930.



### Lester F. Lingle

Born:  
Birth Place:  
Father's Birth Place:  
Mother's Birth Place:

### Irene [Ahern] Lingle

Born:  
Birth Place:  
Father's Birth Place:  
Mother's Birth Place:

**1908** Claibore Triplett sold approximately 10 acres to Thomas and Elva Ahern in May 1908. The Aherns raised cherries and apples on the property. They constructed the packing sheds and other sheds on the property between 1910 and 1915. The farm was called the "Cherry Hill" Fruit Farm when the Aherns had it.<sup>1</sup>

**1920** Mrs. Irene Lingle, of Long Beach, Cal., is visiting her parents, Mr. and Mrs. Thos. Ahern.

*Rogue River Courier*. October 8, 1920. [Hugo](#).

### Cherry Fancy Boxes

---

---

## Lester F. Lingle Family, Hugo Settlers: ca., 1930s - 1950s

**1928** Thomas Ahern died in 1928.<sup>1</sup>

**1932** Elva Ahern owned the 10 Ahern cherry farm.<sup>2</sup>

**Late 1930s Cherry Packing**<sup>3</sup> While at Hugo Beatrice individually hand-packed dark-red Bing and Lambert cherries for John Peterson, and later for the Lingle family. The Lingle family's orchard was up the hill from John's orchard, but both were north of the railroad tracks. Royal Anns were not packed because they were too perishable. Packing cherries meant putting cherries into boxes (around 8" x 16" x 6"). You would put the cherries into the boxes in a row trying to place the nicest part of the cherries face-up with the next row covering the stems of the first row. After the first layer of cherries was placed you would place a divider over it and start another layer of cherries. The cherries had to be perfect with no damage or blemishes. The cherries were usually taken to the Hugo depot and shipped by train to San Francisco.

### Cherries & Apples

Mrs. Lingle picked Beatrice out to do the fancy boxes of cherries. She worked faster than Beatrice, but her boxes did not have to be perfect.

---

---

## "Cherry Hill" Fruit Orchard

**1955** Lester F. and Irene [Ahern] Lingle were in possession of the "Cherry Hill" Fruit Farm in 1955.

The Aherns bought the property from the Triplett's. It was used as fruit orchard. The Aherns had a daughter called Irene Ahern and she married Lester Lingle.<sup>5</sup>

**Ahern Road** Lingle maintained that the Ahern Road was a legal road and he had a right to use it across the Peterson place. Mr. Peterson said he is not going through there. There was a big fight and a lot of discord over the years over the use of the Ahern Road by Lingle. The reason Lingle wanted to use the upper road (i.e., Ahern Road) was because it was higher and, therefore, drier in the winter, then the other road which went south and had wetness problems.<sup>5</sup>

**Want more information?** Contact an officer of the *Hugo Neighborhood* on how you can become involved in your community's history and land use.

---

1. Hugo Neighborhood. 2008. *Aherns: Hugo's Early Settlers*. Hugo, OR.

2. Metsher, Chas. F. *1932 Metsker Map. Josephine County, Oregon*. Portland, OR.

3. Hugo Neighborhood. 2001. *Draft - Beatrice June (Decker) Bentson's Hugo Memories: 1924 - 2001*. Hugo, OR.

4. Metsher, Chas. F. *1955 Metsker Map. Josephine County, Oregon*. Portland, OR.

5. Walker Mike. January 27, 2008. *Wayne Mcky Interview about Hugo Neighbors Identified on the 1932 Metsker Map*. Hugo, OR.

## Hugo Neighborhood Association & Historical Society's Mission

This information brochure is one of a series of documents published by the Hugo Neighborhood Association & Historical Society (*Hugo Neighborhood*). It is designed to be shared with neighbors for the purpose of helping protect our rural quality of life by promoting an informed citizenry in decision-making. The *Hugo Neighborhood* is an informal nonprofit charitable and educational organization with a land use and history mission of promoting the social welfare of its neighbors.

### Land Use & History

The *Hugo Neighborhood's* land use mission is to promote Oregon Statewide Goal 1 — Citizen Involvement, and to preserve, protect, and enhance the livability and economic viability of its farms, forests, and rural neighbors. It will act, if requested, as a technical resource assisting neighbors to represent themselves.

Its history mission is to educate, collect, preserve, interpret, and research its local history and to encourage public interest in the history of the Hugo area.

Volunteer membership dues are \$10.00 annually per family and normally used for paper, ink, envelopes, publications and mailings. Send us your e-mail address if you want to know what we are doing.

Email: [hugo@jeffnet.org](mailto:hugo@jeffnet.org)

Web Page: <http://jeffnet.org/~hugo/>

Edited by Jean Boling, Jacque Hardwick, Karen Rose,  
Wayne and Janet McKy, & Mike Walker

### HNA&HS Officers

Hal Anthony, Outreach Chair  
3995 Russell Road  
Grants Pass, Oregon 97526

Wayne McKy, Chair  
6497 Hugo Road  
Grants Pass, Oregon 97526

Mike Walker, Education Chair  
3388B Merlin Rd #195  
Grants Pass, Oregon 97526

Karen Rose, Web Master  
575 Red Mountain Drive  
Grants Pass, Oregon 97526

Not Quality Controlled, Nor Edited

## LINGLE'S CHERRY HILL FRUIT ORCHARD



Very Draft  
Brochure 248 Of Hugo's Early  
Settler Brochure Series

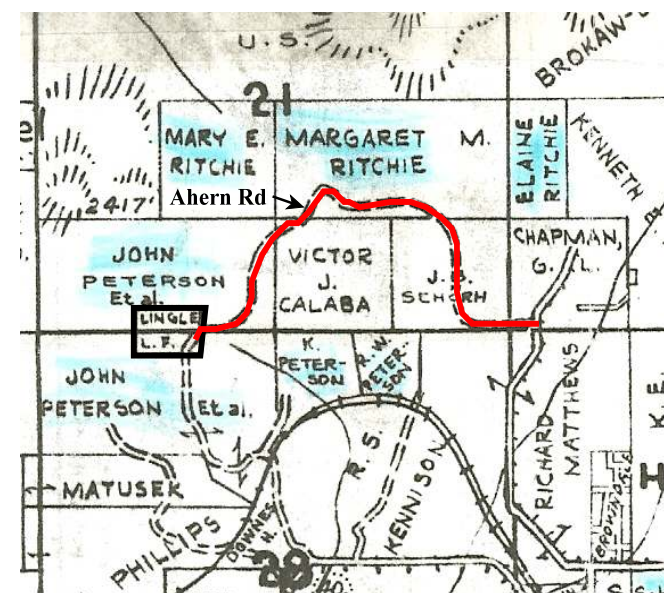

*Lingle's Cherry Hill Fruit Orchard: 1955*

June 3, 2009

Hugo Neighborhood Association &  
Historical Society

Josephine County Historical Society

Brochure 248 in Hugo's Early Settler Brochure Series  
HNA&HS 2009 -248

C:\Documents and Settings\mike\My Documents\Genealogy\History\_Brochures\People Settlers 1900 -  
1930s\BROCHURE\_248 Lingle L. F. 060309.wpd