

Hugo's Early Settlers

For purposes of the Hugo's Settler brochure series, an early Hugo settler includes anyone who lived, worked, or owned property there sometime from 1900 through the 1930s.

Charles Ellis

Born: 1898
 Birth Place: Oregon
 Father's Birth Place: Massachusetts
 Mother's Birth Place: Oklahoma

Agnes Ellis

Born: 1902
 Birth Place: Oregon
 Father's Birth Place: Nebraska
 Mother's Birth Place: Michigan

1929 Pleasant Valley Cemetery¹

Ellis, Alberta June b. d. 2/2/1929

"Beloved daughter of Charles & Agnes."¹ Shared stone with James & Joseph Murtha.

The Charles Ellis Family, Hugo Settlers: 19?? - 19??

1930 Census. Lucky Queen Precinct, Josephine County, Oregon

Charles Ellis	Head	OR	1898	32 yrs
Agnes Ellis	Wife	OR	1902	28 yrs
Orin J. Ellis	Son	OR	1924	6 yrs
Dayma A Ellis	Dau	OR	1925	5 yrs
Elva L. Ellis	Dau	OR	1927	3 yrs
Bert Ellis	Brother	OR	1903	27 yrs

Charles' occupation was farming land that he owned.
 Bert's occupation was a laborer working on a farm.

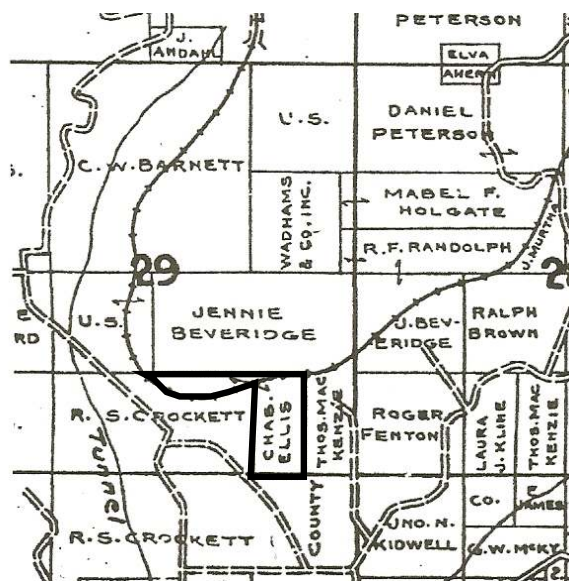

Charles Ellis' Hugo Tract: 1932

Tunnel Creek

1932 Chas. Ellis had possession of a odd shaped tract that straddled the Southern Pacific Railroad in Hugo, Oregon. The northern boundary was adjacent to a locally known fruit farmer, Jennie Beveridge.²

Want more information? Contact an officer of the *Hugo Neighborhood* on how you can become involved in your community's history and land use.

1. Internet.net. October 22, 2007. *Pleasant Valley Cemetery, Hugo, Josephine County, Oregon*. Contributed by Jean Boling.
 2. Metsker, Chas. F. 1932 *Metsker Map, Josephine County, Oregon*. Portland, OR.

Hugo Neighborhood Association & Historical Society's Mission

This information brochure is one of a series of documents published by the Hugo Neighborhood Association & Historical Society (*Hugo Neighborhood*). It is designed to be shared with neighbors for the purpose of helping protect our rural quality of life by promoting an informed citizenry in decision-making. The *Hugo Neighborhood* is an informal nonprofit charitable and educational organization with a land use and history mission of promoting the social welfare of its neighbors.

Land Use & History

The *Hugo Neighborhood's* land use mission is to promote Oregon Statewide Goal 1 — Citizen Involvement, and to preserve, protect, and enhance the livability and economic viability of its farms, forests, and rural neighbors. It will act, if requested, as a technical resource assisting neighbors to represent themselves.

Its history mission is to educate, collect, preserve, interpret, and research its local history and to encourage public interest in the history of the Hugo area.

Volunteer membership dues are \$10.00 annually per family and normally used for paper, ink, envelopes, publications and mailings. Send us your e-mail address if you want to know what we are doing.

Email: hugo@jeffnet.org
Web Page: <http://jeffnet.org/~hugo/>
Edited by Karen Rose, Wayne McKy, & Mike Walker

HNA&HS Officers

Hal Anthony, Outreach Chair
3995 Russell Road
Grants Pass, Oregon 97526

Wayne McKy, Chair
6497 Hugo Road
Grants Pass, Oregon 97526

Mike Walker, Education Chair
3388B Merlin Rd #195
Grants Pass, Oregon 97526

Karen Rose, Web Master
575 Red Mountain Drive
Grants Pass, Oregon 97526

Not Quality Controlled, Nor Edited

Brochure 108 in Hugo's Early Settler Brochure Series
HNA & HS 2008 - 108
C:\Documents and Settings\mike\My Documents\Genealogy\History_Brochures\People Settlers 1900 -
1930s\BROCHURE_108 Ellis Charles 021008.wpd

CHARLES ELLIS FAMILY: HUGO SETTLERS



Very Draft
Brochure 108 Of Hugo's Early
Settler Brochure Series



January 30, 2008

**Hugo Neighborhood Association &
Historical Society**