

Hugo's Early Settlers

For purposes of the Hugo's Settler brochure series, an early Hugo settler includes anyone who lived, worked, or owned property there sometime from 1900 through the 1930s.

Mary J. Dubois

Born:

Birth Place:

Father's Birth Place:

Mother's Birth Place:

??

Born:

Birth Place:

Father's Birth Place:

Mother's Birth Place:

Simple ancestry search for Josephine County, Oregon
1930. 1- 40 names. No Josephine County Dubois.
1/30/08

The Mary Dubois Family, Early Hugo Settlers: ca., 1900s - 1930s

1908 Mary Dubois' Cash Entry Dubois purchased 156.72 acres under Cash Entry No. 15365 in Josephine County, Oregon. It was issued October 5, 1908 to Mary J. Dubois (April 24, 1820: Sale-Cash Entry (3 Stat. 566)).¹⁻²

This tract is high in the Quartz Creek drainage, much higher than any agricultural lands.

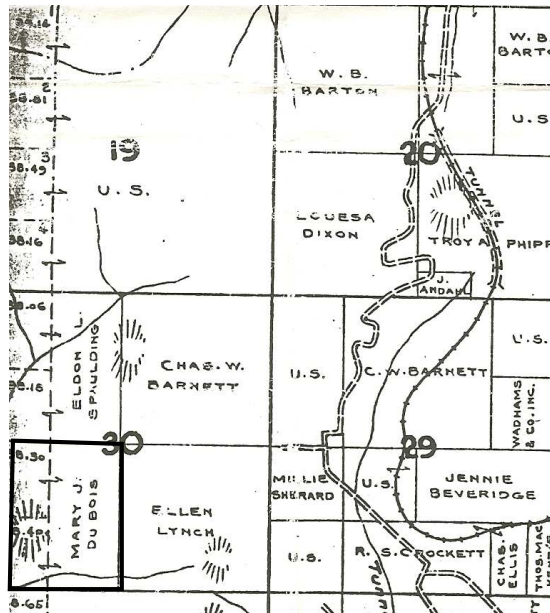

Mary DuBois' Hugo Cash Entry: 1932

Cash Entry Tract

1932 Mary J. Dubois was in possession of her original 1908 cash entry tract in 1932.³

Want more information? Contact an officer of the *Hugo Neighborhood* on how you can become involved in your community's history and land use.

1. Bureau of Land Management (BLM), General Land Office (GLO) Records. 2007. Official Federal Land Records Site (<http://www.glorerecords.blm.gov/>). Internet.
2. Hugo Neighborhood. 2007. *Hugo Pioneers*. Map Of Federal Land Transfer in Hugo, Oregon. Hugo, OR.
3. Metsher, Chas. F. 1932 *Metsker Map. Josephine County, Oregon*. Portland, OR.

Hugo Neighborhood Association & Historical Society's Mission

This information brochure is one of a series of documents published by the Hugo Neighborhood Association & Historical Society (*Hugo Neighborhood*). It is designed to be shared with neighbors for the purpose of helping protect our rural quality of life by promoting an informed citizenry in decision-making. The *Hugo Neighborhood* is an informal nonprofit charitable and educational organization with a land use and history mission of promoting the social welfare of its neighbors.

Land Use & History

The *Hugo Neighborhood's* land use mission is to promote Oregon Statewide Goal 1 — Citizen Involvement, and to preserve, protect, and enhance the livability and economic viability of its farms, forests, and rural neighbors. It will act, if requested, as a technical resource assisting neighbors to represent themselves.

Its history mission is to educate, collect, preserve, interpret, and research its local history and to encourage public interest in the history of the Hugo area.

Volunteer membership dues are \$10.00 annually per family and normally used for paper, ink, envelopes, publications and mailings. Send us your e-mail address if you want to know what we are doing.

Email: hugo@jeffnet.org
Web Page: <http://jeffnet.org/~hugo/>
Edited by Karen Rose, Wayne McKy, & Mike Walker

HNA&HS Officers

Hal Anthony, Outreach Chair
3995 Russell Road
Grants Pass, Oregon 97526

Wayne McKy, Chair
6497 Hugo Road
Grants Pass, Oregon 97526

Mike Walker, Education Chair
3388B Merlin Rd #195
Grants Pass, Oregon 97526

Karen Rose, Web Master
575 Red Mountain Drive
Grants Pass, Oregon 97526

Not Quality Controlled, Nor Edited

DUBOIS FAMILY: HUGO SETTLERS



Very Draft
Brochure 104 Of Hugo's Early
Settler Brochure Series



			Luther Williamson Pat. 14023 (1908)	BLI
BLM	Tunnel No. 9		Edward Dixon Patent 12054 1904	Alber Osbor Pat. 50 (1901)
Florence Snodgrass Pat. 15357 (1908)	Charles Barnett Pat. 018063 (1930)	BLM	Sylvester Decker Pat. 015846 1929	BL
Mary DuBois Pat. 15365 (1908)	Ellen Lynch Pat. 15358 (1908)	Railroad Pat 38 (1896)	BLM Railroad	Railroad Pat 38 (1896)
		BLM	Railroad Pat 38 (1896)	Mackinzi Trimble

Mary DuBois' Hugo Cash Entry: 1908

January 30, 2008

Hugo Neighborhood Association &
Historical Society