

## Hugo's Early Settlers

For purposes of the Hugo's Settler brochure series, an early Hugo settler includes anyone who lived, worked, or owned property there sometime from 1900 through the 1930s.

### James S. Douglas

Born:

Birth Place:

Father's Birth Place:

Mother's Birth Place:

ca., 1910s - 1930s W. Soloman

**1910 Hugo's Fine Soils** Some of the leading owners of the property at Hugo got together recently and discussed the conditions of soil in their neighborhood and the crops best adapted to them. It was finally decided to secure the services of Professor O'Gara, the United States soil expert, and get his opinions on this important subject., so as to enable them to commence right. Professor O'Gara made the examination and gave his report, in which he says that apples, pears, peaches, cherries, and grapes will grow to perfection in that locality and that all of them would be profitable crops.<sup>1</sup>

These owners were: W. Soloman. D. C. Abrams, Robert Randolph, Wm. McKenzie, S. Sehorn, John Peterson, John R. Beegle. S. S. Beveridge, Dr. F. E. Holgate, H. E. Martin, J. M. Hall, Robert Crockett, Thomas H. Ahern, and D. H. Heller. The action of the Hugo land owners is an object lesson for the many who are clearing and planting lands in this country.<sup>1</sup>

## James S. Douglas Family, Hugo Settler Family: 19?? - 19??

W. Soloman would take the lesson to heart and developed a large peach orchard on approximately 20 - 30 acres of land.

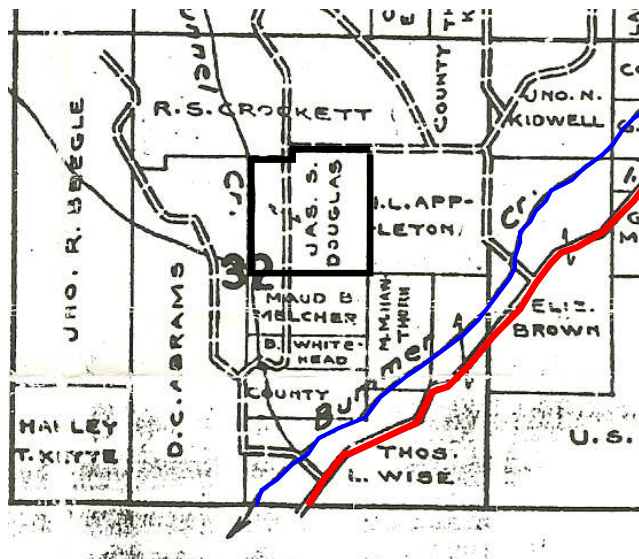

*James S. Douglas' Hugo Farm: 1932*

## Soloman Peach Orchard



**1932** Approximately 40 acres of the old Soloman Peach orchard parcel on Tunnel Creek just north of its confluence with Bummer Creek was in the possession of Jas. S. Douglas in 1932.<sup>2</sup>

The Douglas parcel was part of the old Rowe homestead (see 1939 aerial

photograph on title page).

**Want more information?** Contact an officer of the *Hugo Neighborhood* on how you can become involved in your community's history and land use.

1. *Rogue River Courier*. November 4, 1910. Hugo's Fine Soils.  
2. Metsher, Chas. F. 1932 *Metsker Map*. Josephine County, Oregon. Portland, OR.

## Hugo Neighborhood Association & Historical Society's Mission

This information brochure is one of a series of documents published by the Hugo Neighborhood Association & Historical Society (*Hugo Neighborhood*). It is designed to be shared with neighbors for the purpose of helping protect our rural quality of life by promoting an informed citizenry in decision-making. The *Hugo Neighborhood* is an informal nonprofit charitable and educational organization with a land use and history mission of promoting the social welfare of its neighbors.

### Land Use & History

The *Hugo Neighborhood's* land use mission is to promote Oregon Statewide Goal 1 — Citizen Involvement, and to preserve, protect, and enhance the livability and economic viability of its farms, forests, and rural neighbors. It will act, if requested, as a technical resource assisting neighbors to represent themselves.

Its history mission is to educate, collect, preserve, interpret, and research its local history and to encourage public interest in the history of the Hugo area.

Volunteer membership dues are \$10.00 annually per family and normally used for paper, ink, envelopes, publications and mailings. Send us your e-mail address if you want to know what we are doing.

Email: [hugo@jeffnet.org](mailto:hugo@jeffnet.org)

Web Page: <http://jeffnet.org/~hugo/>

Edited by Karen Rose, Wayne McKy, & Mike Walker

### HNA&HS Officers

Hal Anthony, Outreach Chair  
3995 Russell Road  
Grants Pass, Oregon 97526

Wayne McKy, Chair  
6497 Hugo Road  
Grants Pass, Oregon 97526

Mike Walker, Education Chair  
3388B Merlin Rd #195  
Grants Pass, Oregon 97526

Karen Rose, Web Master  
575 Red Mountain Drive  
Grants Pass, Oregon 97526

**Not Quality Controlled, Nor Edited**

## JAMES S. DOUGLAS FAMILY: HUGO SETTLERS



**Very Draft**  
Brochure 103 Of Hugo's Early  
Settler Brochure Series

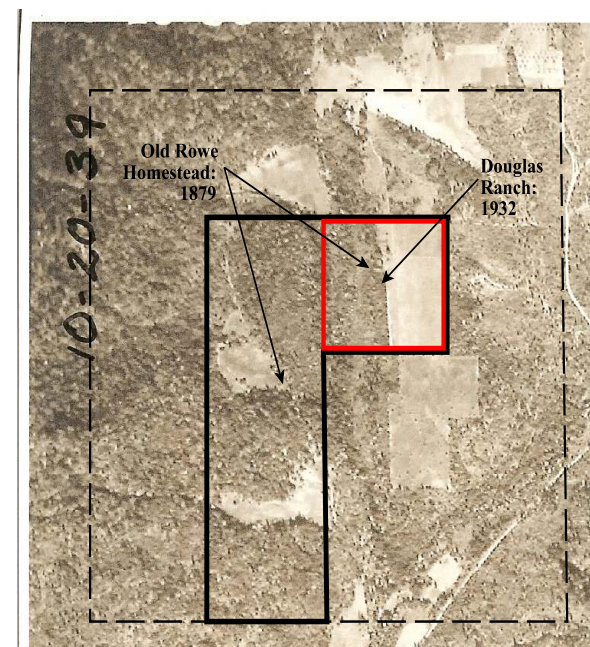

*Douglas' 40 Acre Ranch Was Part Of  
Original 1879 Rowe Homestead: 1939*

**May 5, 2009**

**Hugo Neighborhood Association &  
Historical Society**

Brochure 103 in Hugo's Early Settler Brochure Series  
HNA&HS 2009 -103

C:\Documents and Settings\mike\My Documents\Genealogy\History\_Brochures\People Settlers 1900 -  
1930s\BROCHURE\_103 Douglas James 050509.wpd