

Oregon Department Of Transportation (ODOT) Archives

ROW Research Members of the GLO Field Review SubCommittee, Hugo Emigrant Trails Committee, decided to travel to the ODOT archives in Salem, Oregon. Their agenda was to research materials for applicability to the Hugo *history* research program on the *Trail* and highways, and potential aerial photos for purchase



at ODOT's History Center and Maps and Plans Center. Kelly Rarey and Mike Walker found two 24" 1940 "B" roll maps for Sexton Mountain.¹⁻²

- 1. North Side Of Sexton Mt.** Sunny Valley to Area Near Section Corner for Section 22, 23, 26, & 27 (17.5' Roll "B" Map Drawing No. 5B-28-11)¹.
- 2. South Side Of Sexton Mt.** Area Near Section Corner for Section 22, 23, 26, & 27 (13.5' Roll "B" Map Drawing No. 5B-30-9)² to Hugo Interchange.

Why were the roll maps produced? They were probably used to prepare legal descriptions for proposed property acquisitions (i.e., used by ROW agents and appraisers in preparation to acquire property).

Engineering Roll Maps - the most common type of map produced by ROW engineering (i.e., A - C).

- "A" 36" width mostly used for interchange Projects or where r/w is extensive
- "B" 24" width standard map size used
- "C" 12" width used on small projects, BLM filing maps, survey approval, etc.

310' Segment of Applegate Trail (Trail) On South Side Of Mt. Sexton Pass

1940 South Trail At Mt. Sexton Pass The 310' segment of the *Trail* on the south side of Mt. Sexton Pass is scientifically located by engineers on Oregon Highway Drawing. No. 5B-28-11.¹ The "South Edge" of the 310' segment is located 505' East and 598' south from the 1/4 corner of sections 22 and 23, T.34.S., R.6 W., W.M. The "South Edge" is the middle of the county road where it first intersects the right-of-way for the Pacific Telephone and Telegraph (PTT) line.



310' South Trail At Sexton Pass: 2003

The average course of the *Trail* was 44.5" true per the 1940 Drawing No. 5B-28-11.¹

The average physical width of the 310' segment of the *Trail* was nine feet (9') as measured in the field. The drawing measurements ranged from 8' - 10', but predominately 8' - 9' within 310' of the PTT ROW crossing.¹

1. Oregon State Highway Department. August 1940. *Right of Way Map, Sexton Mt. Section. Pacific Highway, Josephine County.* Scale 1" = 100'. Part 1 of 2, Drg. No. 5B-28-11.
2. Oregon State Highway Department. December 1940. *Right of Way Map, Sexton Mt. Section. Pacific Highway, Josephine County.* Scale 1" = 100'. Part 2 of 2, Drg. No. 5B-30-9.

1940 Sexton Mt. Right-of-Way (ROW) Engineering Roll Maps

1941 The "*Right-of-way Cleared on Sexton*" photo is courtesy of the *Grants Pass Courier* from its January 6, 1941 edition.⁴ The *Trail* in photo is the same *Trail*

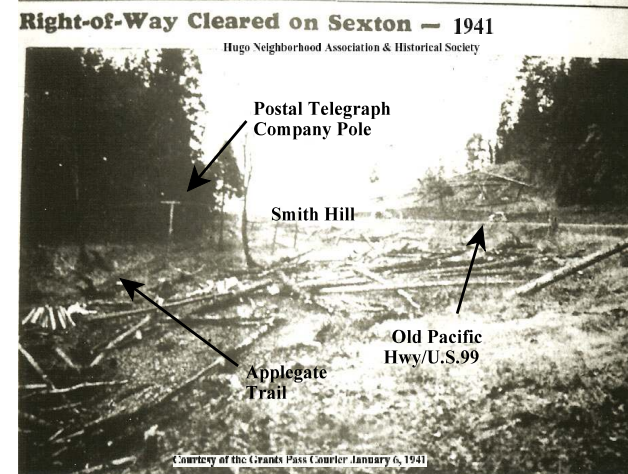

Photo 1. Right-of-Way Cleared On Sexton: 1941

identified on the Oregon Highway Drawing. No. 5B-28-11.¹

"The residence overlooking the Pacific highway summit [Smith Hill] on the shoulder of Mt. Sexton has been razed, and trees are being felled for 1.92 miles of new construction soon to take place there. Here is a view toward the summit from the Grants Pass side showing the steep, old dirt road on the left [Applegate Trail], the curving present highway on the right [Old Pacific Highway/U.S. 99], and the felled trees on the right-of-way of the new work. The highway summit will be lowered several feet by a deep cut. (Courier Photo and Engraving)."

Hugo Emigrant Trails Committee (HETC)

Hugo is blessed with a rich heritage of historic roads, rough though they were. The *Hugo Emigrant Trails Committee* was formed to bring together all those who want to learn more about the early transportation in the area, from the casual admirer to the dedicated researcher. Its aim is to collect and record information about Hugo's emigrant trails, especially its two historic 1850s General Land Office mapped roads, and to share this information (e.g., through *Hugo History Day*, talks, hikes, group visits, training exercises, workshops, publications, web sites, etc.).

Karen Rose, Co-Project Leader
Mike Walker, Co-Project Leader

Diaries, Journals & Reminiscences SubCommittee

Jean Boling
Glen Campbell
Janet McKy
Joe Neiderheiser
Leta Neiderheiser
Berneata Rarey
Kelly Rarey
Karen Rose
Mike Walker

General Land Office Field Survey SubCommittee

Terall Blalock
Glen Campbell
Jim Ford
Rene Ford
Joe Neiderheiser
Kelly Rarey
Mike Walker
Chris Wytcherley

Brochure 18L in Hugo's Native American Brochure Series
HNA & HS 2011 -18L

C:\Documents and Settings\mike\My Documents\Genealogy\Applegate Trail GLO Surveyed Points\JA14
Maple Creek\BROCHURE 18L JA15L 1940 OHD Map 101711.wpd

Hugo Neighborhood Association & Historical Society's Mission

This information brochure is one of a series of documents published by the Hugo Neighborhood Association & Historical Society (*Hugo Neighborhood*). It is designed to be shared with neighbors for the purpose of helping protect our rural quality of life by promoting an informed citizenry in decision-making. The *Hugo Neighborhood* is an informal nonprofit charitable and educational organization with a land use and history mission of promoting the social welfare of its neighbors.

Land Use & History

The *Hugo Neighborhood's* land use mission is to promote Oregon Statewide Goal 1 — Citizen Involvement, and to preserve, protect, and enhance the livability and economic viability of its farms, forests, and rural neighbors. It will act, if requested, as a technical resource assisting neighbors to represent themselves.

Its history mission is to educate, collect, preserve, interpret, and research its local history and to encourage public interest in the history of the Hugo area. Volunteer membership dues are \$10.00 annually per family and normally used for paper, ink, envelopes, publications and mailings.

Hugo Neighborhood

3388B Merlin Rd # 195, Grants Pass, Oregon 97526
541-471-8271

Email: hugo@jeffnet.org

Web Page: <http://www.hugoneighborhood.org/>

Edited by Jean Boling, Joe Neiderheiser,
Kelly Rarey, Karen Rose, & Mike Walker

1940 Right-of-Way Map, South Sexton Pass Trail, & Pacific Highway



Brochure 18L of Applegate Trail GLO
Surveys Brochure Series

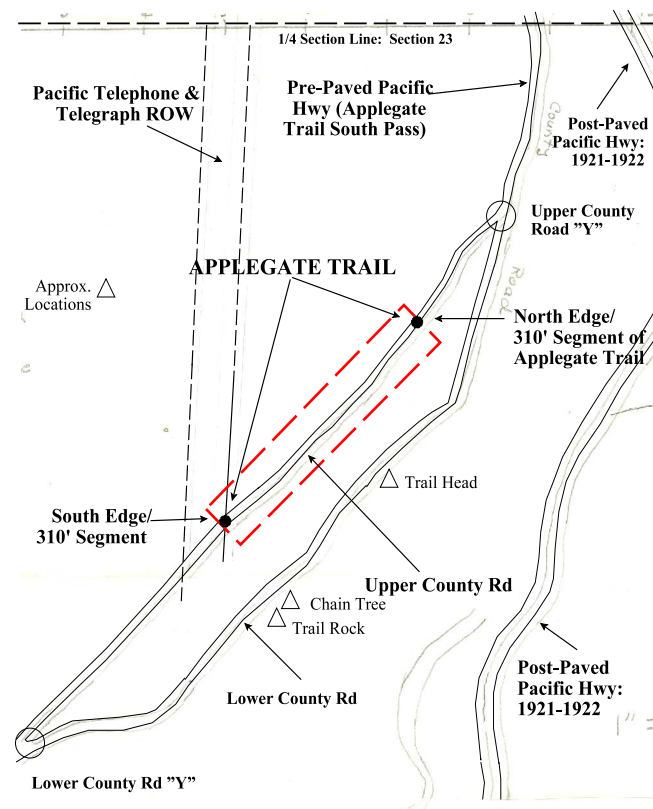

**310' Segment of Applegate Trail on
South Side of Mt. Sexton Pass: 1940**
Base Map Oregon Highway Drawing No. 5B-28-11

October 17, 2011

**Hugo Neighborhood Association &
Historical Society
Josephine County Historical Society**