

## History

**Homesteaders.** George T. McCormick homesteaded 80-acres that would become the White place (Figure 1 & Photo 1). His application number was 5029 for which he received a patent (No. 3164) in 1893. The Applegate Trail's location was through the homestead. In 1895 George's neighbor was another homesteader, Hugo Garber (i.e., Hugo's namesake - Figure 1).

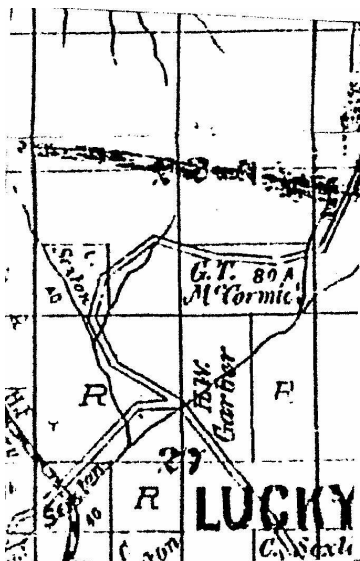

Figure 1. 1895 Map<sup>2</sup>

### Owners of the White Property<sup>2</sup>

- 1932 - Phoebe Ward
- 1955 - Alva E. Watts
- 1970 - Walt White

1. Metsker maps.  
2. Joseph Koch, Draughtsman. 1895. *Official Map of Josephine County, Oregon*. Grants Pass, OR  
3. Wyman White Interview, January 15, 2006.

## White's Place

**1960/1961** The White family arrived in Hugo in the early 1960s: father Walter, mother, Elaine, and sons John, Tom, Wyman, and Jeff.<sup>3</sup> Since they arrived the land around the White home had been grassland and old walnut orchards.



Photo 1. White Property: 2002

An old concrete culvert was there which always had a pretty good hole downstream where the White brothers, Jeff and Wyman, had found wagon artifacts (e.g., wood barrow stays and hoops, wooden spoke wagon hubs, iron with wood spokes, etc.). The brothers had grown up with an old road (Photo 2 - title page) going east-west across the entire 80-acres. It was a narrow, winding, relatively level roadbed on a moderate slope. This very old roadbed could be the old emigrant wagon road before the cutoff.

East of the culvert crossing are some cement slabs where old-timers had told Jeff and Wyman they had parked the stage coaches (Photo 3). In this area the White family found many items associated with a stage coach line (e.g., old tackle, iron buckles, horseshoes, etc.). There used to be three barns similar to the one still standing on the property.

## More Information

The lower part of the White's old driveway was east and up slope of present day Hasis Drive. Parallel to the driveway was the postal telegraph line with the triangular split poles, including cross members, and glass insulators. The junction of White's old driveway with Hugo Road is today the green gate driveway. Jeff found a 1910 dime here while waiting for the school bus.



Photo 3. Old Culvert Crossing & Barn: 2006

**Be Respectful** Do not trespass. The White Property is private property not open to the public.

**More Information** Do you have information about the White place? Please share it with Wyman White and/or the *Hugo Neighborhood*.

Wyman White  
2091 Dowell Road  
Grants Pass, Oregon 97527  
541-471-4121

## Hugo Neighborhood Association & Historical Society's Mission

This information brochure is one of a series of documents published by the Hugo Neighborhood Association & Historical Society (*Hugo Neighborhood*). It is designed to be shared with neighbors for the purpose of helping protect our rural quality of life by promoting an informed citizenry in decision-making. The *Hugo Neighborhood* is an informal nonprofit charitable and educational organization with a land use and history mission promoting the social welfare of its neighbors.

### Land Use & History

The *Hugo Neighborhood's* land use mission is to promote Oregon Statewide Goal 1 — Citizen Involvement, and by preserving, protecting, and enhancing the livability and economic viability of its farms, forests, and rural neighbors. It will act, as requested, as a technical resource assisting neighbors to represent themselves.

Its history mission is to collect, preserve, interpret, and research its local history and to encourage public interest in the history of the Hugo area.

Membership dues are \$10.00 annually and due in January. They are used for paper, ink, envelopes, publications, and mailings. Make checks to the *Hugo Neighborhood* and send them to our Treasurer. Send us your e-mail address if you want to know what we are doing.

*Hugo Neighborhood*

Email: [hugo@jeffnet.org](mailto:hugo@jeffnet.org)

Web Page: <http://jeffnet.org/~hugo/>

Edited by Jean Boling, Wayne McKy, Kelly Rarey, Karen Rose, Wyman White, Jeff White, & Mike Walker

### HNA&HS Officers

Wayne McKy, Chair  
6497 Hugo Road  
Grants Pass, Oregon 97526

Mike Walker, Education Chair  
3388B Merlin Rd #195  
Grants Pass, Oregon 97526

Hal Anthony, Outreach Chair  
3995 Russell Road  
Grants Pass, Oregon 97526

Jacqueline Hardwick, Treasurer  
885 Red Mountain Drive  
Grants Pass, Oregon 97526

Karen Rose, Web Master  
575 Red Mountain Drive  
Grants Pass, Oregon 97526

Ann Lyneis, Secretary  
5100 Tunnel Loop Road  
Grants Pass, Oregon 97526

Brochure 17DB in Emigrant Trails Brochure Series - HNA&HS 2006 - 19  
C:\Documents and Settings\mike\My Documents\Genealogy\Applegate Trail  
GLO Surveyed Points\JA13 Penny Ridge\BROCHURE 17DB White Property  
051806.wpd

## WHITE'S PLACE & APPLEGATE TRAIL



Brochure 17DB in Emigrant  
Trails Series



*Very Old East-West Road  
Entire Length Of White's Place*

**May 18, 2006**

**Hugo Emigrant Trails Committee  
Hugo Neighborhood Association &  
Historical Society  
Josephine County Historical Society**