

## Jacksonville Road (JR) Of Applegate Trail (Trail): Niday Road North (JA-12)<sup>1</sup>

**Hugo's Jacksonville Road (JA) from Willamette Valley to Jacksonville** (route of the Applegate Trail) is located in Josephine County, Oregon from Louse Creek in the south to Grave Creek in the north. There are 17 GLO surveyed points of interest (POI) along the JR in Hugo's area of interest.<sup>2</sup>

### NIDAY ROAD NORTH POI

**Road POI Name** Niday Road North<sup>3</sup> ■ JA-12.

**POI ID Code** OR-AT-00-34-06-27/34-W-JA-12.

**GLO Survey Notes for POI** Page 607. Subdivisions of T. 34 S., R. 6 W. - N89.36, W [West] on true Line between sections 27 & 34.

### Chains

**1.20 Jacksonville Road** c S 60° E  
[1.2 chains = 79.2']  
**4.50 Branch 2 Lks wide** c S E  
**80.00 Set Post Cor to Secs 27.28.33&34**  
[80 chains = 5.280']

### Latitude & Longitude of POI Calculated<sup>3</sup>

42° 34' 45.78" North Latitude  
123° 23' 7.60" West Longitude

**POI Located With GPS** Not yet; with permission.

**Interpretative Sign; Metal Detection Work** Not yet; with permission.

1. Hugo Neighborhood. 2009 *Hugo's Applegate Trail GLO Points of Interest*. Brochure 1 in Applegate Trail GLO Surveys Series. Hugo, OR.

## Diaries, Journals, & Reminiscences<sup>1</sup>

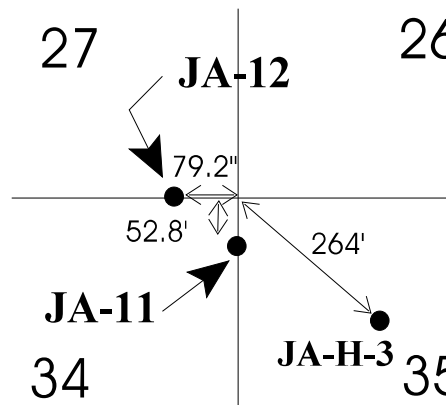

**Private Ownership**  
JA-12 is located 79.2' west along Boyce's south property line from its SE corner which is the joint corner for sections 26, 27, 34,

and 35. It is also located 79.2' west along the Squyres property line from the joint corner.

**Stakeholders** Private landowners: Boyce and Squyres.

Kristin Boyce  
TL 1000, Section 27DD, T.34S., R.6W., WM.  
4.00 acres

Rebecca Squyres  
TL 605, Section 35, T.34S., R.6W., WM.  
5.15 acres

2. Hugo Neighborhood. 2009 *Hugo's Jacksonville Road Of Applegate Trail Points of Interest*. Brochure 2 in Applegate Trail GLO Surveys Series. Hugo, OR.  
3. 1856 General Land Office Field Survey Sub-Committee, Hugo Emigrant Trails Committee, Hugo Neighborhood Association & Historical Society. February 10, 2006. *General Land Office Field Survey Notes: Hugo's Applegate Trail Segments*. Hugo, OR.

## General Land Office (GLO) Surveys & Maps<sup>1</sup>

**Patents** JA-11 of the Trail is located in the northeast part of the Niday donation land claim (DLC; (Patent No.1479). The course of JA-11, JA-12, and three different survey and road courses of NW and SE from the 1857 DLC survey establish part of Hugo and Monterico Road as evolutions of the Trail.

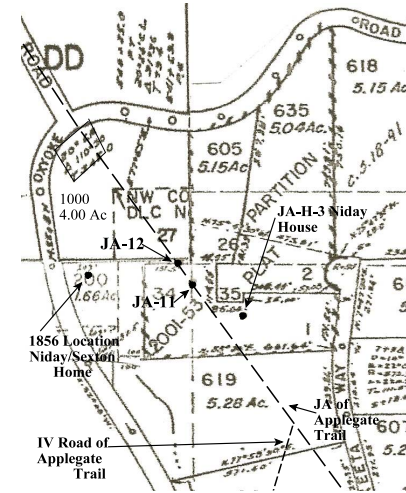

**OCTA Trail Classification** Class ③ or Class ④  
Verified Trail.

**Coherence Rule** Linear Uniformity. Yes  
**Corroborative Rule** Confirming Evidence. Yes  
**Collateral Rule** Physical/Topo Evidence. Yes  
**Correlation Rule** Overall Agreement. Yes

**Be Respectful** *Do not trespass. JA-12 is located on private property not open to the public.*

**Want more information?** Contact an officer of the Hugo Neighborhood on how you can become involved in land use and history in the Hugo community.

## Hugo Emigrant Trails Committee

Hugo is blessed with a rich heritage of historic roads, rough though they were. The *Hugo Emigrant Trails Committee* was formed to bring together all those who want to learn more about the early transportation in the area, from the casual admirer to the dedicated researcher. Its aim is to collect and record information about Hugo's emigrant trails, especially its two historic 1850s General Land Office mapped roads, and to share this information (e.g., through *Hugo History Day*, talks, hikes, group visits, training exercises, workshops, publications, web sites, etc.).

Karen Rose, Co-Project Leader  
Mike Walker, Co-Project Leader

### *Diaries, Journals & Reminiscences SubCommittee*

Karen Rose  
Janet McKy  
Kelly & Berneata Rarey  
Glen Campbell  
Norm Tieman  
Joe & Leta Neiderheiser  
Kristen Boyce  
Kathy Burkey  
Penny Shipley  
Mike Walker

### *General Land Office Field Survey SubCommittee*

Glen Campbell  
Jim & Rene Ford  
Joe Neiderheiser  
Kelly Rarey  
Mike Walker  
Chris Wytcherley

C:\Documents and Settings\mike\My Documents\Genealogy\Applegate Trail  
GLO Surveyed Points\JA12 Niday Road North\BROCHURE 16 JA Niday  
Road North\_JA12 031210.wpd

## Hugo Neighborhood Association & Historical Society's Mission

This information brochure is one of a series of documents published by the Hugo Neighborhood Association & Historical Society (*Hugo Neighborhood*). It is designed to be shared with neighbors for the purpose of helping protect our rural quality of life by promoting an informed citizenry in decision-making. The *Hugo Neighborhood* is an informal nonprofit charitable and educational organization with a land use and history mission of promoting the social welfare of its neighbors.

### Land Use & History

The *Hugo Neighborhood's* land use mission is to promote Oregon Statewide Goal 1 — Citizen Involvement, and to preserve, protect, and enhance the livability and economic viability of its farms, forests, and rural neighbors. It will act, if requested, as a technical resource assisting neighbors to represent themselves.

Its history mission is to educate, collect, preserve, interpret, and research its local history and to encourage public interest in the history of the Hugo area. Volunteer membership dues are \$10.00 annually per family and normally used for paper, ink, envelopes, publications and mailings.

### *Hugo Neighborhood*

3388B Merlin Rd # 195, Grants Pass, Oregon 97526  
541-471-8271  
Email: hugo@jeffnet.org

Edited by Jean Boling, Kelly Rarey,  
Karen Rose, & Mike Walker

## JR Of Applegate Trail: Niday Road North (JA-12)



Very Draft for Review & Editing  
Brochure 16 of Applegate Trail GLO  
Surveys Brochure Series

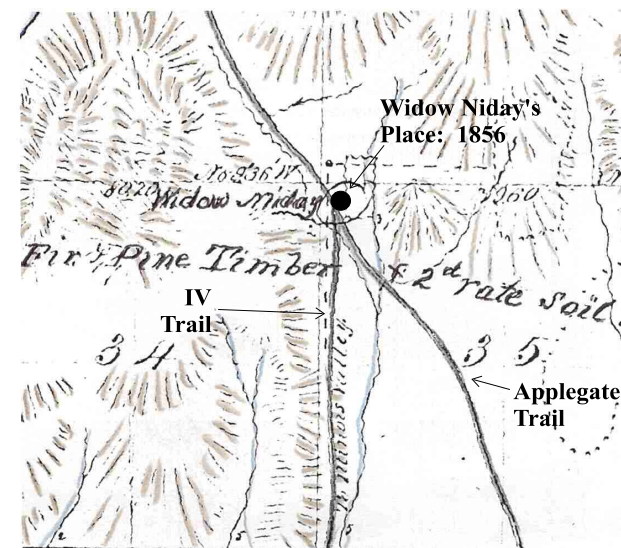

1856 General Land Office Map

March 7, 2010

Hugo Emigrant Trails Committee  
Hugo Neighborhood Association &  
Historical Society  
Josephine County Historical Society