

## Jacksonville Road (JR) Of Applegate Trail (*Trail*): Schoolhouse Ridge (JA-8)<sup>1</sup>

**Hugo's Jacksonville Road (JA) from Willamette Valley to Jacksonville** (route of the Applegate Trail) is located in Josephine County, Oregon from Louse Creek in the south to Grave Creek in the north. There are 17 GLO surveyed points of interest (POI) along the JR in Hugo's area of interest.<sup>2</sup>

### SCHOOLHOUSE RIDGE POI

**Road POI Name** Schoolhouse Ridge<sup>3</sup> ■ JA-8.

**POI ID Code** OR-AT-00-35-06-11/14-W-JA-08.

**GLO Survey Notes for POI** Page 22, Subdivisions of Township N<sub>0</sub> 35 South of Range N<sub>0</sub> 6 W, West on True Line between sections 11 & 14.

### Chains

36.00 Stream 2 lks [Links] wide C NW  
40.00 Road to Jacksonville c N SE  
[40.00 chains = 2,640 feet]  
47.50 to a swale plain

### Latitude & Longitude of POI Calculated<sup>3</sup>

42° 32' 7.0" North Latitude  
123° 22' 31.5" West Longitude

**POI Located With GPS** Not yet; with permission.

**Interpretative Sign; Metal Detection Work** Not yet; with permission.

1. Hugo Neighborhood. 2009 *Hugo's Applegate Trail GLO Points of Interest*. Brochure 1 in Applegate Trail GLO Surveys Series. Hugo, OR.  
2. Hugo Neighborhood. 2009 *Hugo's Jacksonville Road Of Applegate Trail Points of Interest*. Brochure 2 in Applegate Trail GLO Surveys Series. Hugo, OR.

## Diaries, Journals, & Reminiscences<sup>1</sup>

**Patents** JA-8 is located on the SE corner of the Squier homestead; on the western boundary of the Davis Military Warrant; and on the NE corner of the Cox homestead.

**1927 Homestead** On March 9, 1927 Edward Markham Squier was issued a 120 acre homestead patent in Hugo, Oregon (Patent No. 014565).

**1861 Military Warrant** On November 11, 1861 President Abraham Lincoln issued John Davis and Lewis Heatt a military warrant (Patent No. 41877) for 160 acres in Josephine County, Oregon.

**1899 Homestead** On May 31, 1899 William M. Cox ("Junior") were issued a homestead patent for 160 acres in Hugo, Oregon (Patent No. 4550).

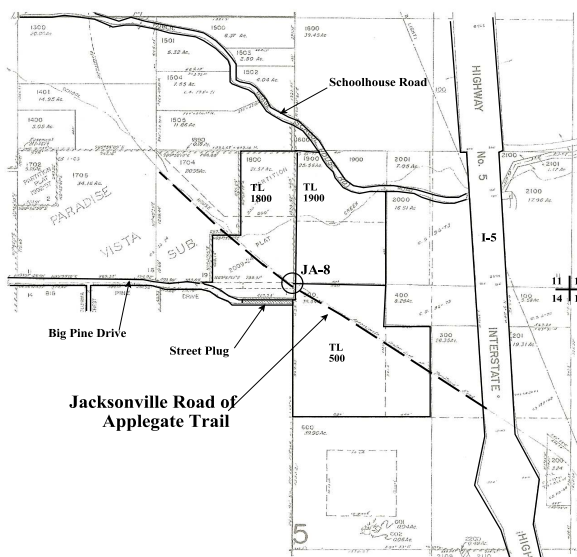

## General Land Office (GLO) Surveys & Maps<sup>1</sup>

**Stakeholders** JA-8 is located on private property defined by three private tax lots.

### Keith Lowrey

Tax Lot 1180 (21.57 ac), Sec. 11, T.35S., R.6W., W.M.

### Paul Feinberg

Tax Lot 1900 (25.56 ac), Sec. 11, T.35S., R.6W., W.M.  
Tax Lot 500 (35.84 ac), Sec. 14, T.35S., R.6W., W.M.

**OCTA Trail Classification** Class ③ or Class ④  
Verified Trail.

**Coherence Rule** Linear Uniformity. Yes  
**Corroborative Rule** Confirming Evidence. Yes  
**Collateral Rule** Physical/Topo Evidence. No  
**Correlation Rule** Overall Agreement. Yes

**Be Respectful** *Do not trespass. JA-8 is located on private property not open to the public.*

**Want more information?** Contact the *Hugo Neighborhood* on how you can become involved in land use and history in the Hugo community.

3. 1856 General Land Office Field Survey Sub-Committee, Hugo Emigrant Trails Committee, Hugo Neighborhood Association & Historical Society. February 10, 2006. *General Land Office Field Survey Notes: Hugo's Applegate Trail Segments*. Hugo, OR.

## Hugo Neighborhood Association & Historical Society's Mission

This information brochure is one of a series of documents published by the Hugo Neighborhood Association & Historical Society (*Hugo Neighborhood*). It is designed to be shared with neighbors for the purpose of helping protect our rural quality of life by promoting an informed citizenry in decision-making. The *Hugo Neighborhood* is an informal nonprofit charitable and educational organization with a land use and history mission of promoting the social welfare of its neighbors.

### Land Use & History

The *Hugo Neighborhood's* land use mission is to promote Oregon Statewide Goal 1 — Citizen Involvement, and to preserve, protect, and enhance the livability and economic viability of its farms, forests, and rural neighbors. It will act, if requested, as a technical resource assisting neighbors to represent themselves.

Its history mission is to educate, collect, preserve, interpret, and research its local history and to encourage public interest in the history of the Hugo area.

Volunteer membership dues are \$10.00 annually per family and normally used for paper, ink, envelopes, publications and mailings. Send us your e-mail address if you want to know what we are doing.

Email: [hugo@jeffnet.org](mailto:hugo@jeffnet.org)  
Web Page: <http://jeffnet.org/~hugo/>  
Edited by Jean Boling, Kelly Rarey,  
Karen Rose & Mike Walker

### HNA&HS Officers

Hal Anthony, Outreach Chair  
3995 Russell Road  
Grants Pass, Oregon 97526

Wayne McKy, Chair  
6497 Hugo Road  
Grants Pass, Oregon 97526

Mike Walker, Education Chair  
3388B Merlin Rd #195  
Grants Pass, Oregon 97526

### Josephine County Historical Society

Jean Boling, Historic Sites Chair  
Josephine County Historical Society  
512 SW 5th Street  
Grants Pass, Oregon 97526

## JR Of Applegate Trail: Schoolhouse Ridge (JA-8)



Brochure 12 of Applegate Trail GLO  
Surveys Brochure Series

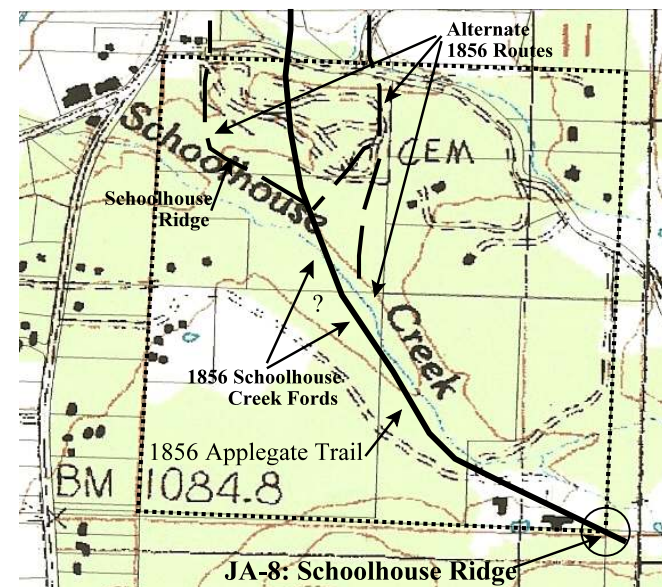

March 7, 2010

Hugo Emigrant Trails Committee  
Hugo Neighborhood Association &  
Historical Society  
Josephine County Historical Society

Brochure 12 of 37: Applegate Trail POI Series -  
HNA&HS 2009 - 72  
C:\Documents and Settings\mike\My Documents\Genealogy\Applegate Trail  
GLO Surveyed Points\JA8 Schoolhouse Ridge\BROCHURE 12 JA  
Schoolhouse Ridge\_JA8 030710.wpd